

PROPOSED SITE
LAYOUT

SOFTBALL FACILITY IS
A CURRENT FACILITY

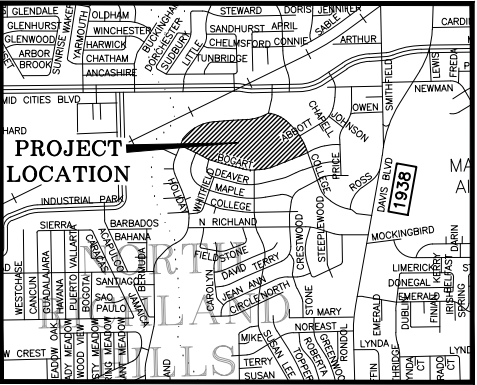
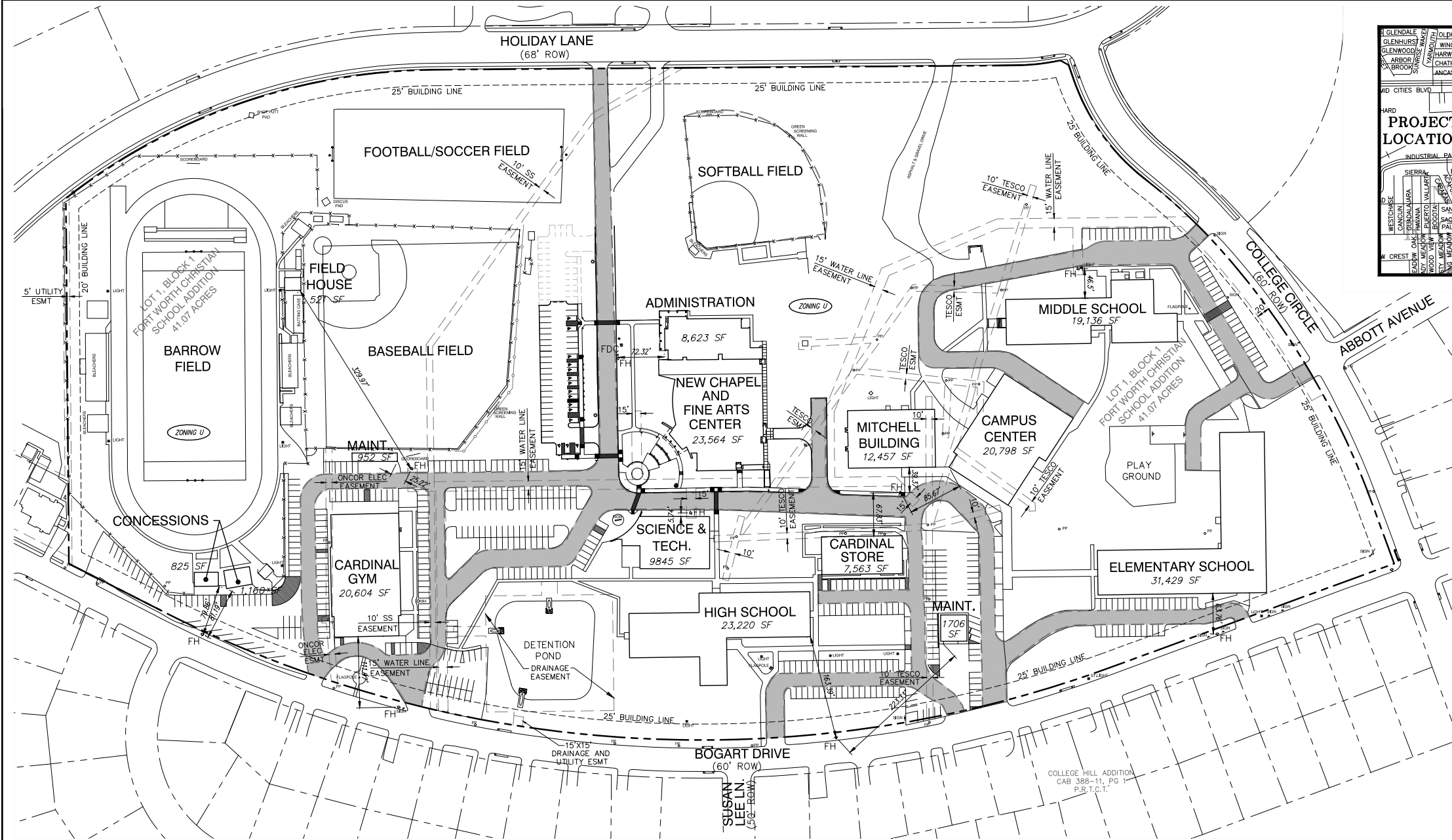

LOCATION MAP
N.T.S.

DATA SUMMARY CHART

EXISTING ZONING	U
GROSS ACRES	41.07 Ac
NET ACRES	41.07 Ac
% OF SITE COVERAGE	41.59%
EXISTING PARKING SPACES	518

STADIUM/BLEACHER SEATING

GYM	
TOTAL SEATS	849
SOFTBALL	
TOTAL SEATS	140
BASEBALL	
TOTAL SEATS	227
*FOOTBALL	
TOTAL SEATS	1430

PARKING REQUIRED
FOR STADIUM SEATING
*1430/3 SEATS = 477

EXISTING FIRELANE

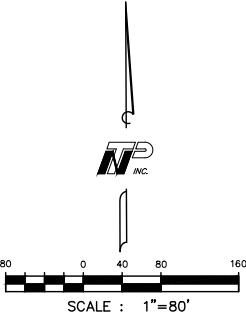

NRH CASE # SP 2011-11

NO.	REVISION	BY	DATE

SCALE
HORIZ
1"=80'
VERT
N/A
DATE
OCT 2013



TEAGUE NALL AND PERKINS

1100 Macon Street
Fort Worth, Texas 76102
Phone:(817)336-6773 • Fax:(817)336-2813
www.tnp-online.com

NORTH RICHLAND HILLS, TEXAS

NEW ADMINISTRATION BUILDING FOR
FORT WORTH CHRISTIAN

COMPREHENSIVE SITE PLAN

TNP PROJECT
HAH1235-00
SHEET
1
OF
1

Fort Worth Christian School Softball

North Richard Hills TX

Lighting System

Pole / Fixture Summary						
Pole ID	Pole Height	Mtg Height	Fixture Qty	Luminaire Type	Load	Circuit
A1	60'	60'	3	TLC-LED-900	2.67 kW	A
		16'	1	TLC-BT-575	0.58 kW	A
		40'	1	TLC-LED-400	0.40 kW	B
A2	60'	60'	3	TLC-LED-900	2.67 kW	A
		16'	1	TLC-BT-575	0.58 kW	A
		40'	2	TLC-LED-400	0.80 kW	B
B1	70'	70'	5	TLC-LED-1200	5.85 kW	A
		16'	1	TLC-BT-575	0.58 kW	A
B2	70'	70'	5	TLC-LED-1200	5.85 kW	A
		16'	1	TLC-BT-575	0.58 kW	A
		40'	2	TLC-LED-400	0.80 kW	B
T1-T4	60'	60'	2	TLC-LED-1200	2.34 kW	C
		60'	1	TLC-LED-900	0.89 kW	C
T5-T8	60'	60'	2	TLC-LED-1200	2.34 kW	D
		60'	1	TLC-LED-900	0.89 kW	D
12			49		47.18 kW	

Circuit Summary			
Circuit	Description	Load	Fixture Qty
A	Softball	19.34 kW	20
B	Security	2.0 kW	5
C	Tennis 1-4	12.92 kW	12
D	Tennis 5-8	12.92 kW	12

Fixture Type Summary							
Type	Source	Wattage	Lumens	L90	L80	L70	Quantity
TLC-LED-1200	LED 5700K - 75 CRI	1170W	136,000	>120,000	>120,000	>120,000	26
TLC-LED-900	LED 5700K - 75 CRI	890W	89,600	>120,000	>120,000	>120,000	14
TLC-BT-575	LED 5700K - 75 CRI	575W	52,000	>120,000	>120,000	>120,000	4
TLC-LED-400	LED 5700K - 75 CRI	400W	46,500	>120,000	>120,000	>120,000	5

Light Level Summary

Calculation Grid Summary								
Grid Name	Calculation Metric	Illumination					Circuits	Fixture Qty
		Ave	Min	Max	Max/Min	Ave/Min		
Blanket Grid	Horizontal Illuminance	15.9	0	68	0.00		A,B,C,D	49
Property Line Spill	Horizontal	0.01	0	0.08	0.00		A,B,C,D	49
Softball (Infield)	Horizontal Illuminance	51.5	38	64	1.67	1.36	A	20
Softball (Outfield)	Horizontal Illuminance	35.2	21	46	2.20	1.68	A	20
Tennis 1-4	Horizontal Illuminance	54.7	35	68	1.93	1.56	C	12
Tennis 5-8	Horizontal Illuminance	53.4	34	67	1.98	1.57	D	12

From Hometown to Professional

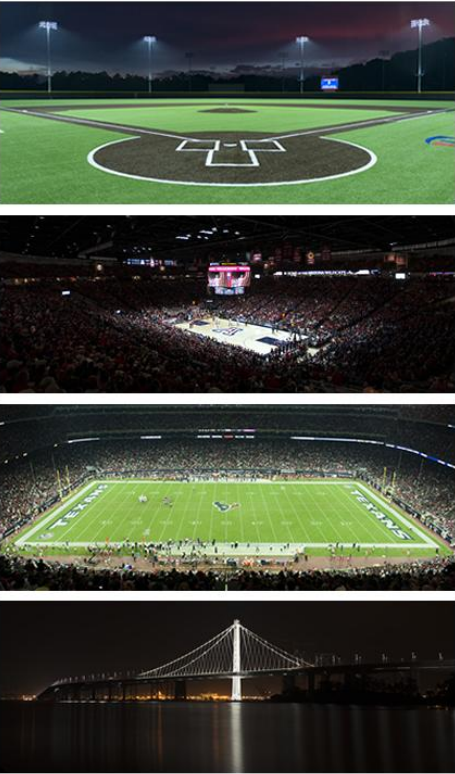

We Make It Happen®

Not to be reproduced in whole or part without the written consent of Musco Sports Lighting, LLC. ©1981, 2022 Musco Sports Lighting, LLC.

Fort Worth Christian School Softball
North Richard Hills TX

GRID SUMMARY	
Name:	Softball
Size:	Irregular 192' / 207' / 183'
Spacing:	20.0' x 20.0'
Height:	3.0' above grade

ILLUMINATION SUMMARY		
MAINTAINED HORIZONTAL FOOTCANDLES		
	Infield	Outfield
Guaranteed Average:	50	30
Scan Average:	51.54	35.19
Maximum:	64	46
Minimum:	38	21
Avg / Min:	1.36	1.70
Guaranteed Max / Min:	2	2.5
Max / Min:	1.67	2.20
UG (adjacent pts):	1.30	1.59
CU:	0.69	
No. of Points:	25	67
LUMINAIRE INFORMATION		
Applied Circuits:	A	
No. of Luminaires:	20	
Total Load:	19.34 kW	

Guaranteed Performance: The ILLUMINATION described above is guaranteed per your Musco Warranty document and includes a 0.95 dirt depreciation factor.

Field Measurements: Individual field measurements may vary from computer-calculated predictions and should be taken in accordance with IESNA RP-6-15.

Electrical System Requirements: Refer to Amperage Draw Chart and/or the "Musco Control System Summary" for electrical sizing.

Installation Requirements: Results assume ± 3% nominal voltage at line side of the driver and structures located within 3 feet (1m) of design locations.

EQUIPMENT LIST FOR AREAS SHOWN								
Pole				Luminaires				
QTY	LOCATION	SIZE	GRADE ELEVATION	MOUNTING HEIGHT	LUMINAIRE TYPE	QTY / POLE	THIS GRID	OTHER GRIDS
1	A1	60'	-	15.5'	TLC-BT-575	1	1	0
				40'	TLC-LED-400	1	0	1
				60'	TLC-LED-900	3	3	0
1	A2	60'	-	15.5'	TLC-BT-575	1	1	0
				40'	TLC-LED-400	2	0	2
				60'	TLC-LED-900	3	3	0
1	B1	70'	-	15.5'	TLC-BT-575	1	1	0
				70'	TLC-LED-1200	5	5	0
1	B2	70'	-	15.5'	TLC-BT-575	1	1	0
				40'	TLC-LED-400	2	0	2
				70'	TLC-LED-1200	5	5	0
4	TOTALS					25	20	5

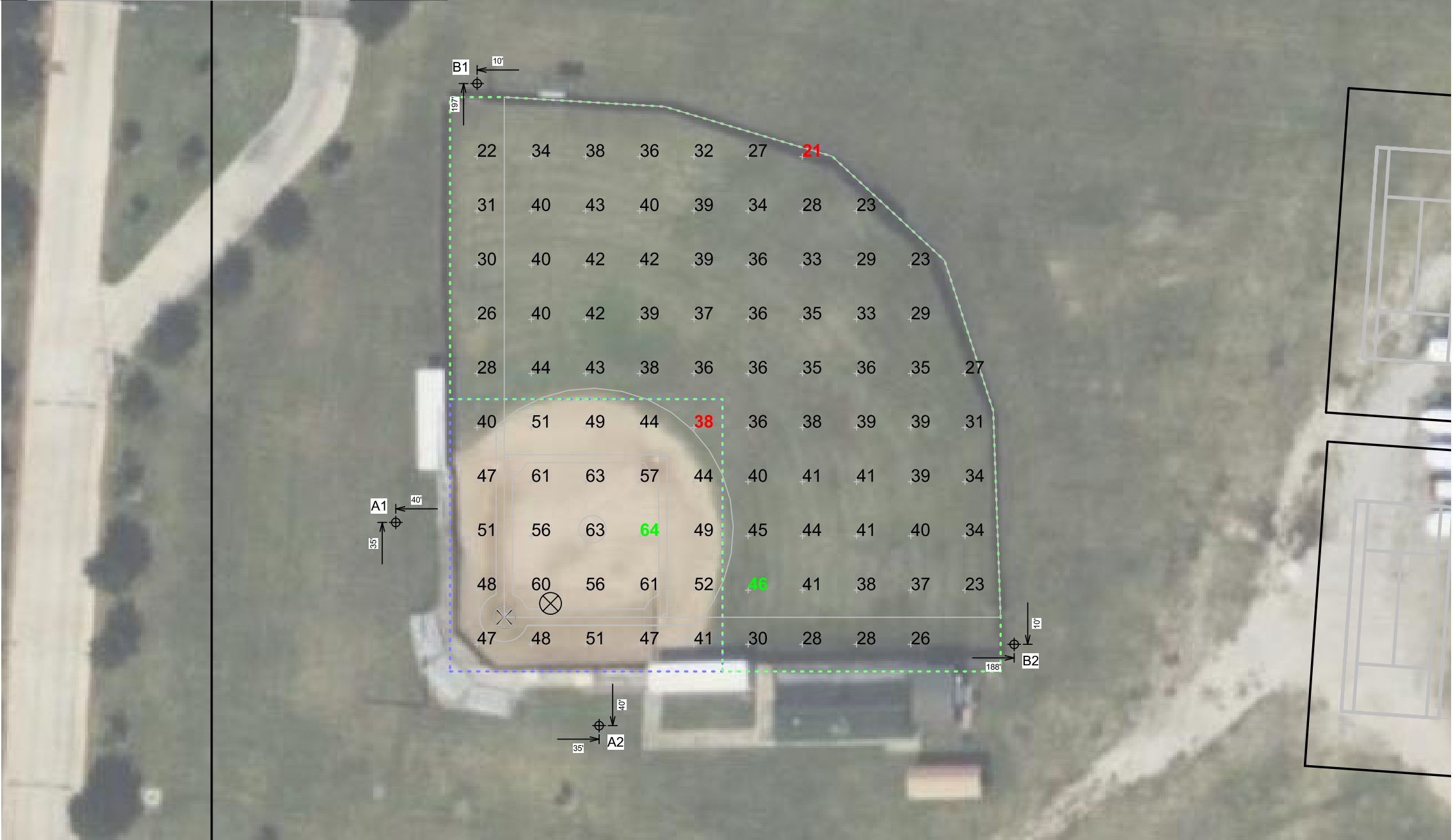

Pole location(s) ⚡ dimensions are relative to 0,0 reference point(s) ⊗



Not to be reproduced in whole or part without the written consent of Musco Sports Lighting, LLC. ©1981, 2022 Musco Sports Lighting, LLC.

ILLUMINATION SUMMARY

Fort Worth Christian School Softball
North Richard Hills TX

GRID SUMMARY

Name: Tennis 1-4
Size: 4 Court - 12' Spacing
Spacing: 20.0' x 20.0'
Height: 3.0' above grade

ILLUMINATION SUMMARY

MAINTAINED HORIZONTAL FOOTCANDLES

Entire Grid
Guaranteed Average: 50
Scan Average: 54.71
Maximum: 68
Minimum: 35
Avg / Min: 1.54
Guaranteed Max / Min: 2
Max / Min: 1.93
UG (adjacent pts): 0.00
CU: 0.92
No. of Points: 60

LUMINAIRE INFORMATION

Applied Circuits: C
No. of Luminaires: 12
Total Load: 12.92 kW

Guaranteed Performance: The ILLUMINATION described above is guaranteed per your Musco Warranty document and includes a 0.95 dirt depreciation factor.

Field Measurements: Individual field measurements may vary from computer-calculated predictions and should be taken in accordance with IESNA RP-6-15.

Electrical System Requirements: Refer to Amperage Draw Chart and/or the "Musco Control System Summary" for electrical sizing.

Installation Requirements: Results assume ± 3% nominal voltage at line side of the driver and structures located within 3 feet (1m) of design locations.

EQUIPMENT LIST FOR AREAS SHOWN								
Pole				Luminaires				
QTY	LOCATION	SIZE	GRADE ELEVATION	MOUNTING HEIGHT	LUMINAIRE TYPE	QTY / POLE	THIS GRID	OTHER GRIDS
4	T1-T4	60'	-	60'	TLC-LED-900	1	1	0
				60'	TLC-LED-1200	2	2	0
4	TOTALS					12	12	0

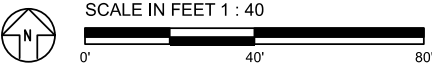

Pole location(s) ⚡ dimensions are relative to 0,0 reference point(s) ⊗



Not to be reproduced in whole or part without the written consent of Musco Sports Lighting, LLC. ©1981, 2022 Musco Sports Lighting, LLC.

ILLUMINATION SUMMARY

Fort Worth Christian School Softball
North Richard Hills TX

GRID SUMMARY

Name: Tennis 5-8
Size: 4 Court - 12' Spacing
Spacing: 20.0' x 20.0'
Height: 3.0' above grade

ILLUMINATION SUMMARY

MAINTAINED HORIZONTAL FOOTCANDLES

Entire Grid

Guaranteed Average: 50
Scan Average: 53.42
Maximum: 67
Minimum: 34
Avg / Min: 1.57
Guaranteed Max / Min: 2
Max / Min: 1.98
UG (adjacent pts): 0.00
CU: 0.90
No. of Points: 60

LUMINAIRE INFORMATION

Applied Circuits: D
No. of Luminaires: 12
Total Load: 12.92 kW

Guaranteed Performance: The ILLUMINATION described above is guaranteed per your Musco Warranty document and includes a 0.95 dirt depreciation factor.

Field Measurements: Individual field measurements may vary from computer-calculated predictions and should be taken in accordance with IESNA RP-6-15.

Electrical System Requirements: Refer to Amperage Draw Chart and/or the "Musco Control System Summary" for electrical sizing.

Installation Requirements: Results assume ± 3% nominal voltage at line side of the driver and structures located within 3 feet (1m) of design locations.

EQUIPMENT LIST FOR AREAS SHOWN								
Pole				Luminaires				
QTY	LOCATION	SIZE	GRADE ELEVATION	MOUNTING HEIGHT	LUMINAIRE TYPE	QTY / POLE	THIS GRID	OTHER GRIDS
4	T5-T8	60'	-	60'	TLC-LED-900	1	1	0
				60'	TLC-LED-1200	2	2	0
4	TOTALS					12	12	0

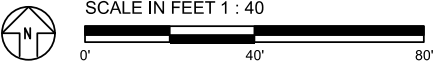

Pole location(s) ⚡ dimensions are relative to 0,0 reference point(s) ⊗



Not to be reproduced in whole or part without the written consent of Musco Sports Lighting, LLC. ©1981, 2022 Musco Sports Lighting, LLC.

ILLUMINATION SUMMARY

Fort Worth Christian School Softball
North Richard Hills TX

EQUIPMENT LIST FOR AREAS SHOWN								
Pole				Luminaires				
QTY	LOCATION	SIZE	GRADE ELEVATION	MOUNTING HEIGHT	LUMINAIRE TYPE	QTY / POLE	THIS GRID	OTHER GRIDS
1	A1	60'	-	15.5'	TLC-BT-575	1	1	0
				40'	TLC-LED-400	1	1	0
				60'	TLC-LED-900	3	3	0
1	A2	60'	-	15.5'	TLC-BT-575	1	1	0
				40'	TLC-LED-400	2	2	0
				60'	TLC-LED-900	3	3	0
1	B1	70'	-	15.5'	TLC-BT-575	1	1	0
				70'	TLC-LED-1200	5	5	0
1	B2	70'	-	15.5'	TLC-BT-575	1	1	0
				40'	TLC-LED-400	2	2	0
				70'	TLC-LED-1200	5	5	0
8	T1-T8	60'	-	60'	TLC-LED-900	1	1	0
				60'	TLC-LED-1200	2	2	0
12	TOTALS					49	49	0



SCALE IN FEET 1 : 80
0' 80' 160'

ENGINEERED DESIGN By: Scott Davis · File #216959B-blanket · 21-Oct-22

Pole location(s) ⚡ dimensions are relative to 0,0 reference point(s) ⊗

GRID SUMMARY	
Name:	Blanket Grid
Size:	685' x 460'
Spacing:	20.0' x 20.0'
Height:	3.0' above grade

ILLUMINATION SUMMARY	
MAINTAINED HORIZONTAL FOOTCANDLES	
Entire Grid	
Scan Average:	15.93
Maximum:	68
Minimum:	0
Avg / Min:	-
Max / Min:	-
UG (adjacent pts):	1141.47
CU:	0.96
No. of Points:	782
LUMINAIRE INFORMATION	
Applied Circuits:	A, B, C, D
No. of Luminaires:	49
Total Load:	47.18 kW

Guaranteed Performance: The ILLUMINATION described above is guaranteed per your Musco Warranty document and includes a 0.95 dirt depreciation factor.

Field Measurements: Individual field measurements may vary from computer-calculated predictions and should be taken in accordance with IESNA RP-6-15.

Electrical System Requirements: Refer to Amperage Draw Chart and/or the "Musco Control System Summary" for electrical sizing.

Installation Requirements: Results assume ± 3% nominal voltage at line side of the driver and structures located within 3 feet (1m) of design locations.



Not to be reproduced in whole or part without the written consent of Musco Sports Lighting, LLC. ©1981, 2022 Musco Sports Lighting, LLC.

ILLUMINATION SUMMARY

Fort Worth Christian School Softball
North Richard Hills TX

GRID SUMMARY	
Name:	Property Line Spill
Spacing:	30.0'
Height:	3.0' above grade

ILLUMINATION SUMMARY	
HORIZONTAL FOOTCANDLES	
Entire Grid	
Scan Average:	0.0122
Maximum:	0.08
Minimum:	0.00
No. of Points:	48
LUMINAIRE INFORMATION	
Applied Circuits:	A, B, C, D
No. of Luminaires:	49
Total Load:	47.18 kW

Guaranteed Performance: The ILLUMINATION described above is guaranteed per your Musco Warranty document.

Field Measurements: Individual field measurements may vary from computer-calculated predictions and should be taken in accordance with IESNA RP-6-15.

Electrical System Requirements: Refer to Amperage Draw Chart and/or the "Musco Control System Summary" for electrical sizing.

Installation Requirements: Results assume ± 3% nominal voltage at line side of the driver and structures located within 3 feet (1m) of design locations.



Not to be reproduced in whole or part without the written consent of Musco Sports Lighting, LLC. ©1981, 2022 Musco Sports Lighting, LLC.

ILLUMINATION SUMMARY

EQUIPMENT LIST FOR AREAS SHOWN								
Pole				Luminaires				
QTY	LOCATION	SIZE	GRADE ELEVATION	MOUNTING HEIGHT	LUMINAIRE TYPE	QTY / POLE	THIS GRID	OTHER GRIDS
1	A1	60'	-	15.5'	TLC-BT-575	1	1	0
				40'	TLC-LED-400	1	1	0
				60'	TLC-LED-900	3	3	0
1	A2	60'	-	15.5'	TLC-BT-575	1	1	0
				40'	TLC-LED-400	2	2	0
				60'	TLC-LED-900	3	3	0
1	B1	70'	-	15.5'	TLC-BT-575	1	1	0
				70'	TLC-LED-1200	5	5	0
1	B2	70'	-	15.5'	TLC-BT-575	1	1	0
				40'	TLC-LED-400	2	2	0
				70'	TLC-LED-1200	5	5	0
8	T1-T8	60'	-	60'	TLC-LED-900	1	1	0
				60'	TLC-LED-1200	2	2	0
12	TOTALS					49	49	0

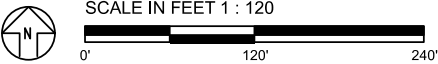

ENGINEERED DESIGN By: Scott Davis · File #216959B-blanket · 21-Oct-22

Pole location(s) ⓧ dimensions are relative to 0,0 reference point(s) ⊗

Fort Worth Christian School Softball
North Richard Hills TX

EQUIPMENT LAYOUT

INCLUDES:

- Blanket Grid
- Softball
- Tennis 1-4
- Tennis 5-8

Electrical System Requirements: Refer to Amperage Draw Chart and/or the "Musco Control System Summary" for electrical sizing.

Installation Requirements: Results assume ± 3% nominal voltage at line side of the driver and structures located within 3 feet (1m) of design locations.

EQUIPMENT LIST FOR AREAS SHOWN						
QTY	LOCATION	Pole		Luminaires		
		SIZE	GRADE ELEVATION	MOUNTING HEIGHT	LUMINAIRE TYPE	QTY / POLE
1	A1	60'	-	15.5'	TLC-BT-575	1
				40'	TLC-LED-400	1
				60'	TLC-LED-900	3
1	A2	60'	-	15.5'	TLC-BT-575	1
				40'	TLC-LED-400	2
				60'	TLC-LED-900	3
1	B1	70'	-	15.5'	TLC-BT-575	1
				70'	TLC-LED-1200	5
1	B2	70'	-	15.5'	TLC-BT-575	1
				40'	TLC-LED-400	2
				70'	TLC-LED-1200	5
8	T1-T8	60'	-	60'	TLC-LED-900	1
				60'	TLC-LED-1200	2
12	TOTALS					49

SINGLE LUMINAIRE AMPERAGE DRAW CHART							
Ballast Specifications (.90 min power factor)		Line Amperage Per Luminaire (max draw)					
Single Phase Voltage		208 (60)	220 (60)	240 (60)	277 (60)	347 (60)	480 (60)
TLC-LED-1200		7.0	6.6	6.1	5.2	4.2	3.0
TLC-LED-900		5.3	5.0	4.6	4.0	3.2	2.3
TLC-BT-575		3.4	3.2	2.9	2.5	2.0	1.5
TLC-LED-400		2.3	2.2	2.0	1.7	1.4	1.0



Pole location(s) ⓧ dimensions are relative to 0,0 reference point(s) ⊗



Not to be reproduced in whole or part without the written consent of Musco Sports Lighting, LLC. ©1981, 2022 Musco Sports Lighting, LLC.