

# Colorado Boulevard

Closure Request



# Colorado Blvd. Closure Request

- Overview of Colorado Boulevard
  - Basic Information
  - Development History
  - Citizen Concerns
- Local Street Network
- Traffic Data
- Resident Survey Responses
- Closure Option

# Colorado Boulevard

Overview / Development History / Citizen Input

# Colorado Boulevard

- Classified as a Local or Residential Street
- Directly connects Harwood (Minor Arterial) and Boulevard 26 (Major Arterial)
- Roadway reconstructed with concrete in 2010 as part of the 2003 Bond Program
- 21 homes with Colorado frontage

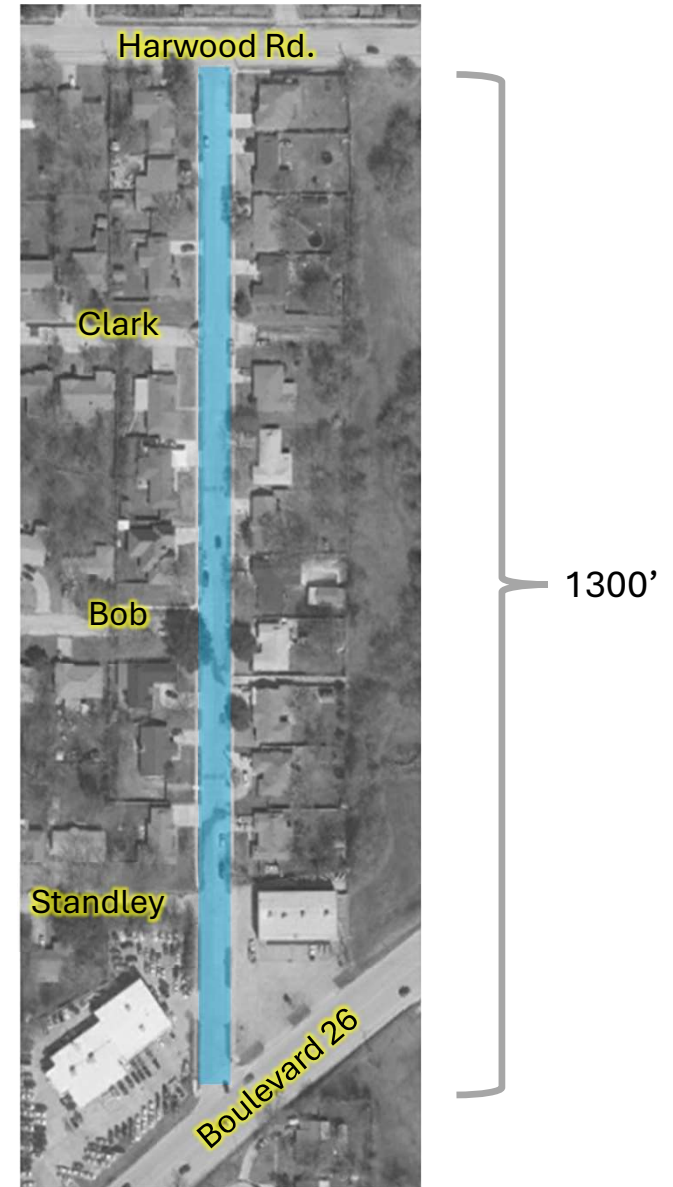

# Neighborhood Background

- Clearview Addition platted in 1958
- Most homes built 1958 – 1960





# Area Growth

- Loop 820
- Boulevard 26 is commercial corridor and regional connection to Grapevine / DFW Airport
- Bedford Euless Road / Strummer commercial development
- Surrounding area >90% developed

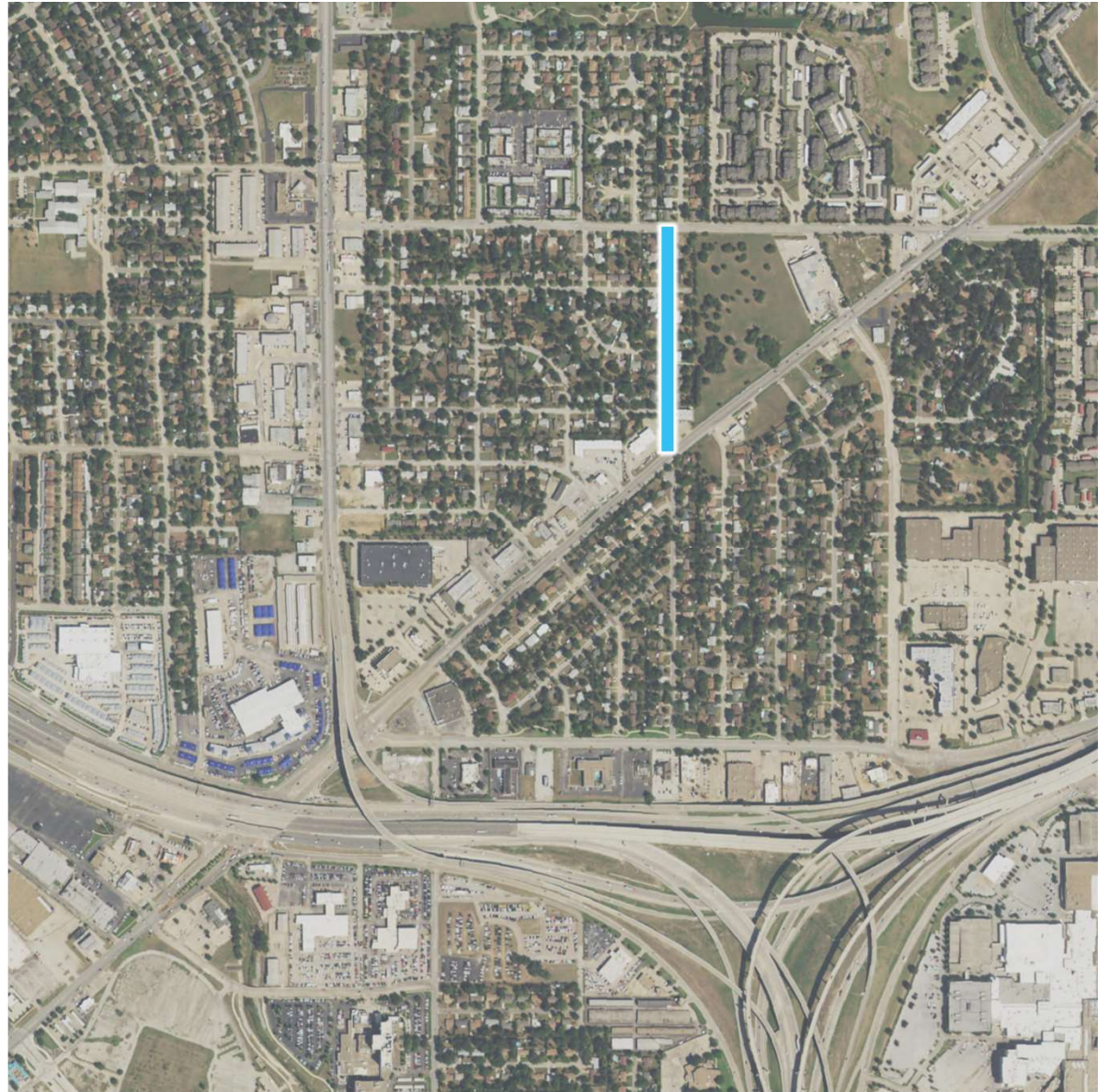

# Citizen Input

- 2009 – Speed Hump Request (considered with street reconstruction but did not receive sufficient resident support)
- 2017 – Speed / Volume data collection
- 2017-2025 – Residents reporting:
  - Speeding
  - High traffic volumes
  - Commercial traffic
  - Vehicles with loud exhaust
  - Incidents between residents and motorists

# Colorado Boulevard

Local Street Network



# Local Street Network

- Richland Oaks and Richhaven Additions south of Boulevard 26 platted in phases from 1955 – 1959



# Local Street Network

- Five direct connections severed between Bedford Euless and Boulevard 26 in early 1990s
- Birchwood closed in 2017



# Colorado Boulevard

Traffic Data



# Currently Installed Traffic Calming Devices



Speed Cushions installed March 2018



# Traffic Volume

Date	Northbound	Southbound
December 2017	387	231
November 2018	223	137
January 2022	354	233
November 2023	506	431



# Traffic Speed

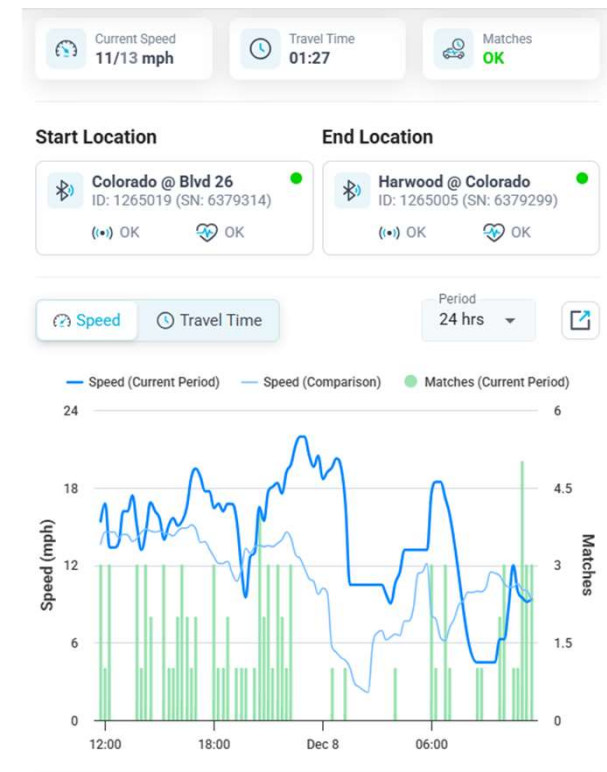
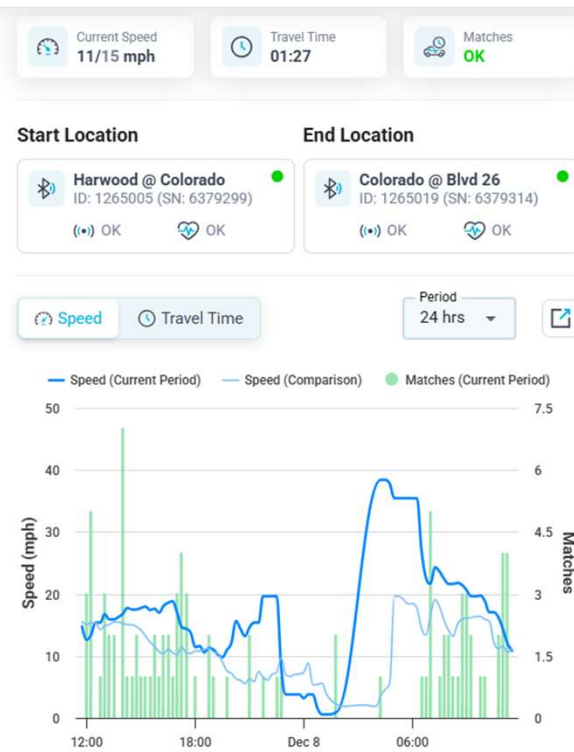
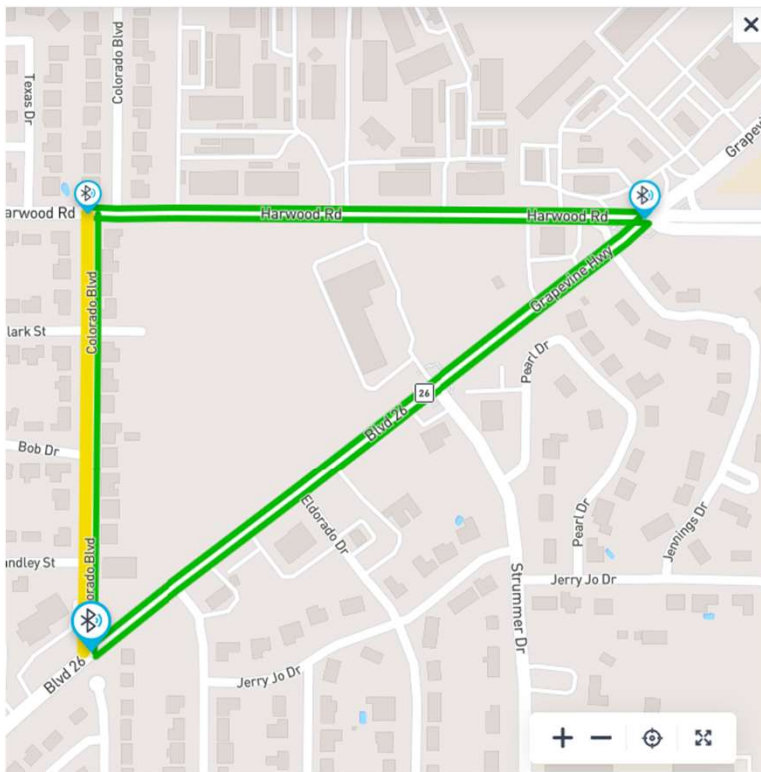



# Traffic Speed

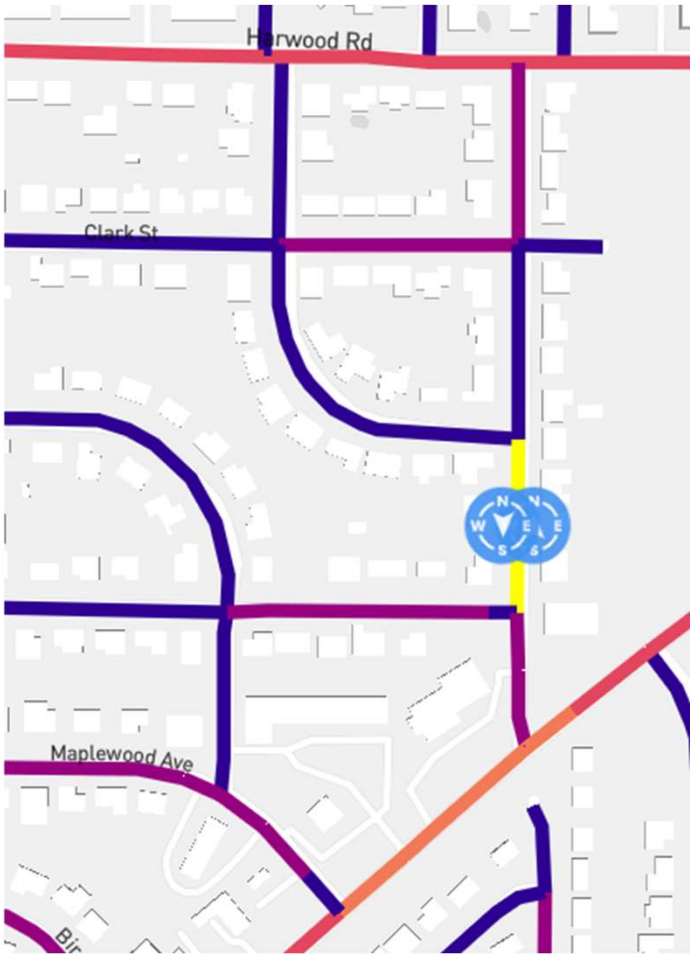
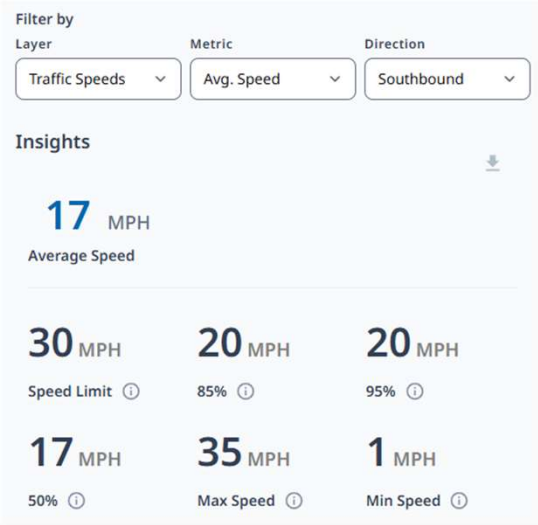
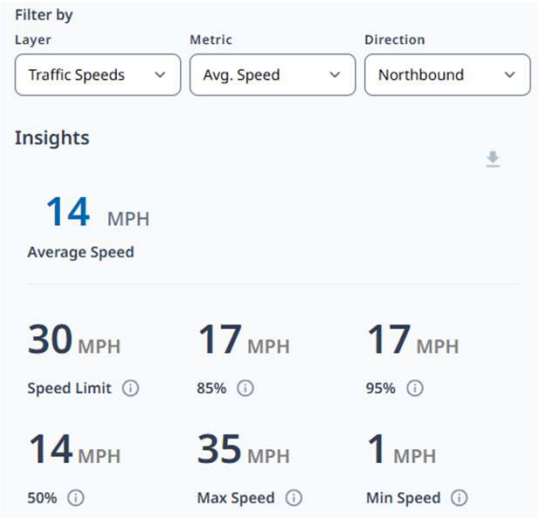

# Traffic Data – Bypass Traffic

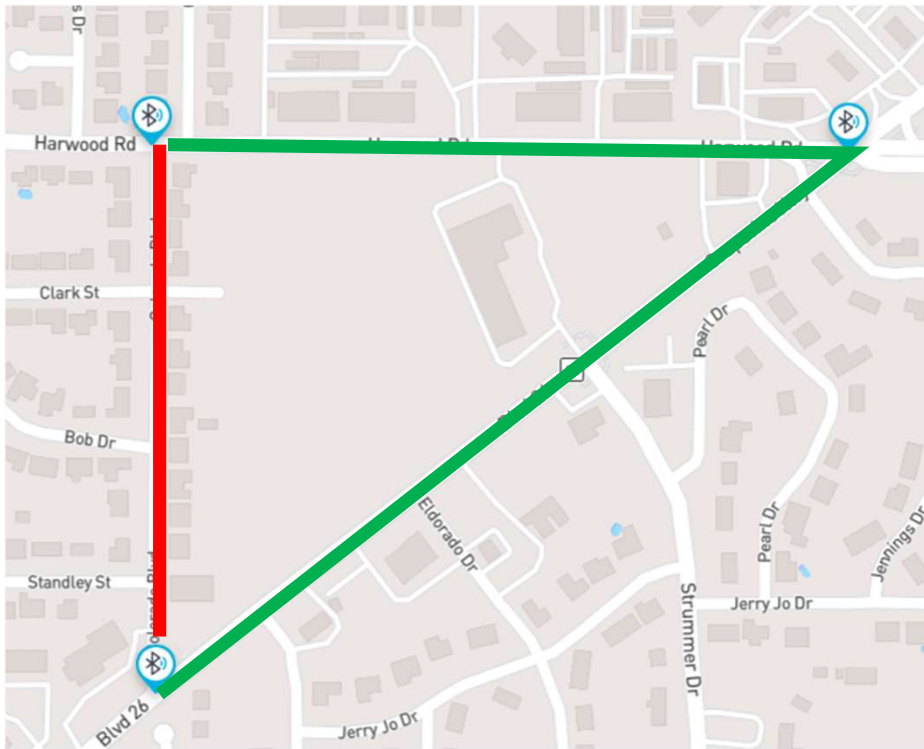

October 2025  
Average trips per day

Via Signal		Bypass	
Northbound	Southbound	Northbound	Southbound
16	14	48	35

# Traffic Data – Bypass Traffic

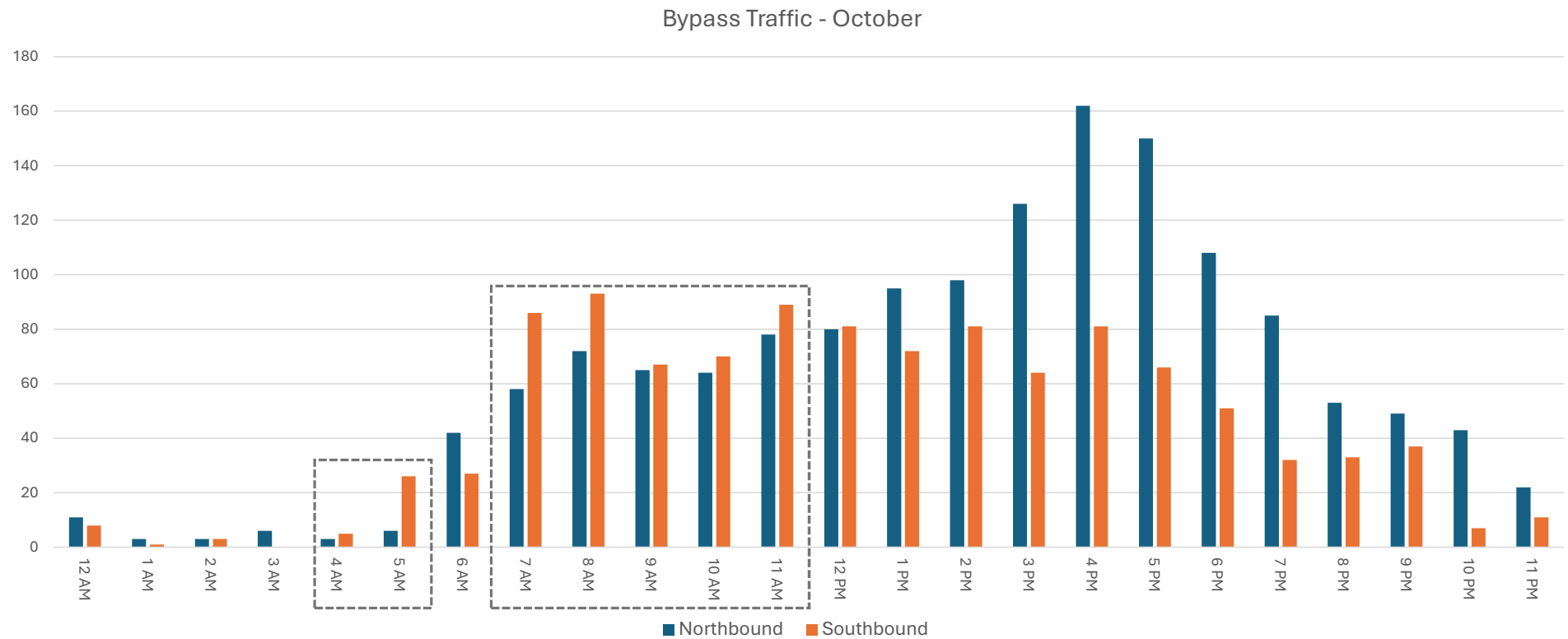

# Colorado Boulevard

Resident Survey Responses

# Neighborhood Survey

Street	Sent	Yes	No	Response Rate
Colorado	21	14	1	71%
Bob	17	0	3	18%
Clark	23	1	13	61%
Grove	15	0	1	7%
Joreen	13	0	2	15%
Maplewood	27	1	2	11%
Standley	31	1	6	23%

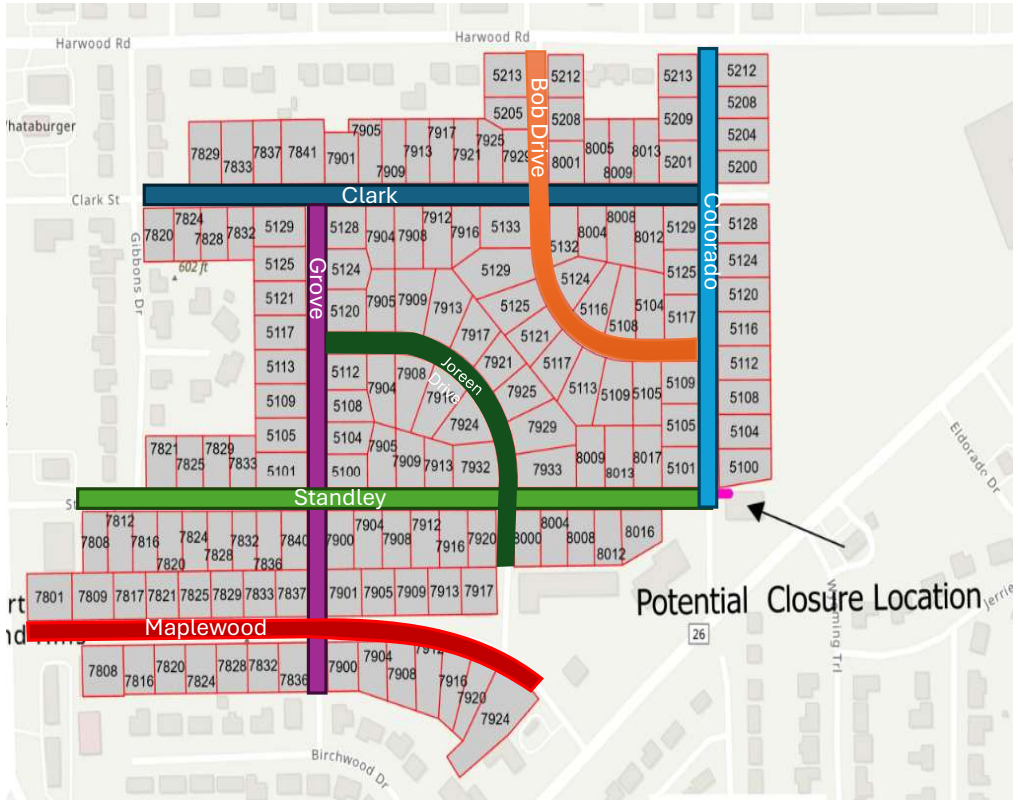

# Survey Results

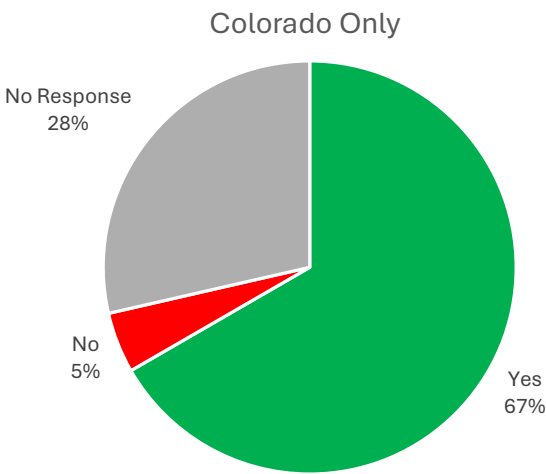
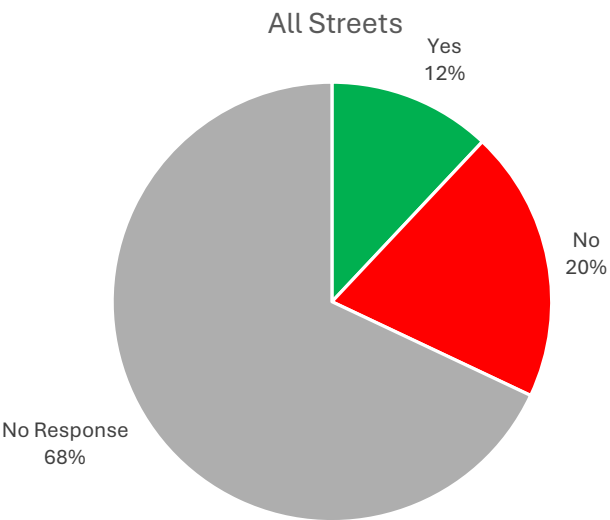
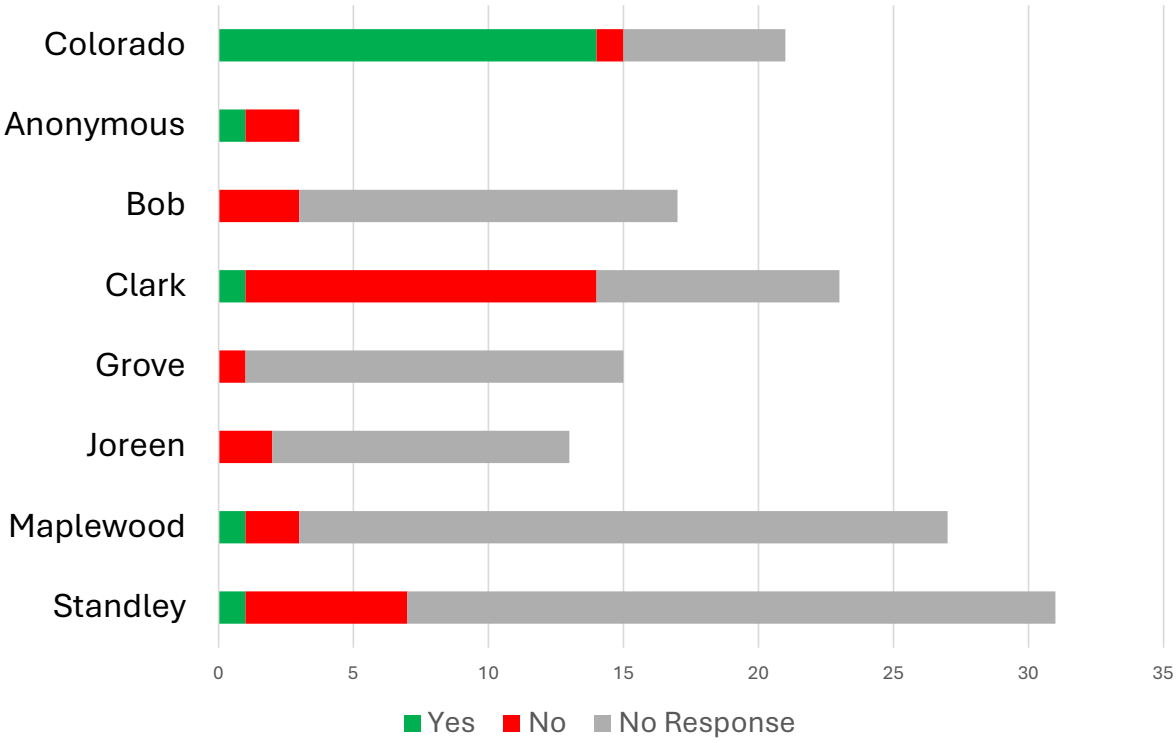



# Survey Results

Reasons property owners **SUPPORT** the closure of Colorado Blvd:

1. *"Safer and more quiet on the street my daughter got hit by a car while crossing the street."*
2. *"People drive very fast down our street, sometimes ignoring the speed bumps."*
3. *"To prevent unnecessary neighborhood traffic cutting through and increase safety for children."*

Reasons property owners **OPPOSE** the closure of Colorado Blvd:

1. *"Emergency access for Fire, Police, and Ambulance."*
2. *"Easier access to Blvd 26."*
3. *"It was extremely inconvenient when the road was closed for months when they were doing work. I had to drive around the long way to get to Harwood."*

# Colorado Boulevard

Closure Option

# Closure Option

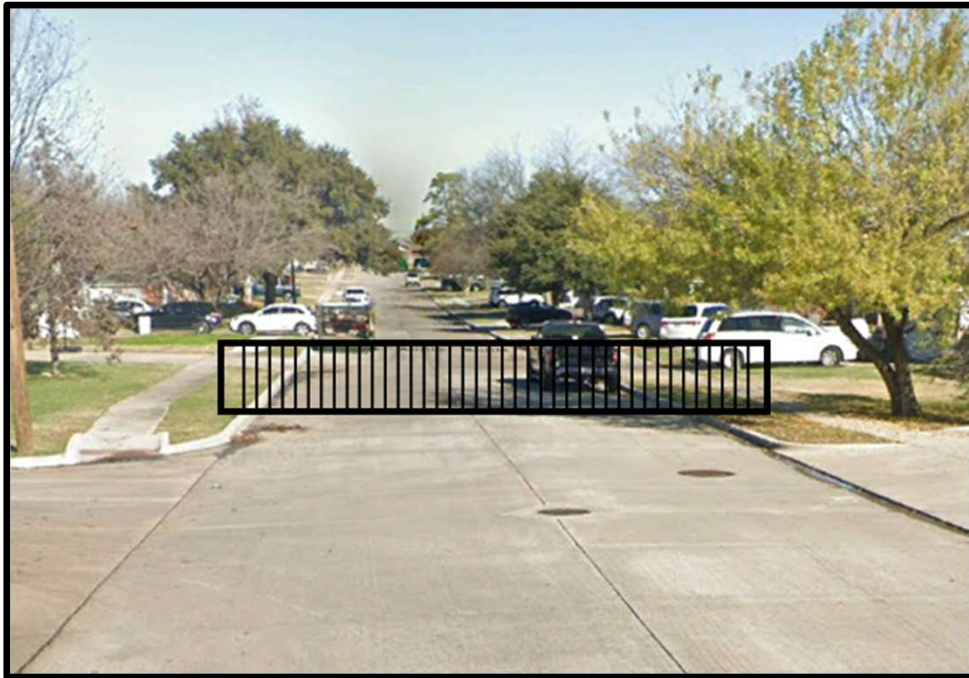

# Questions & Council Feedback