

04/20/26 - 1:44:41 - 45/800 - 1/8000
 LAST DATED 4/20/26 1:39:45
 DWS: DWTY
 KIMLEY-HORN AND ASSOCIATES, INC.
 13455 NOEL ROAD, SUITE 700
 DALLAS, TEXAS 75240
 PHONE: (972) 919-2931
 CONTACT: CHRISTOPHER DELLS, P.E.

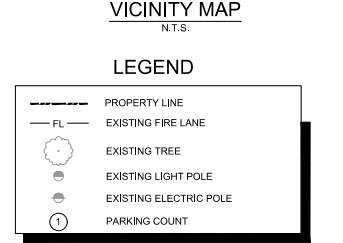
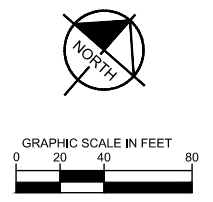
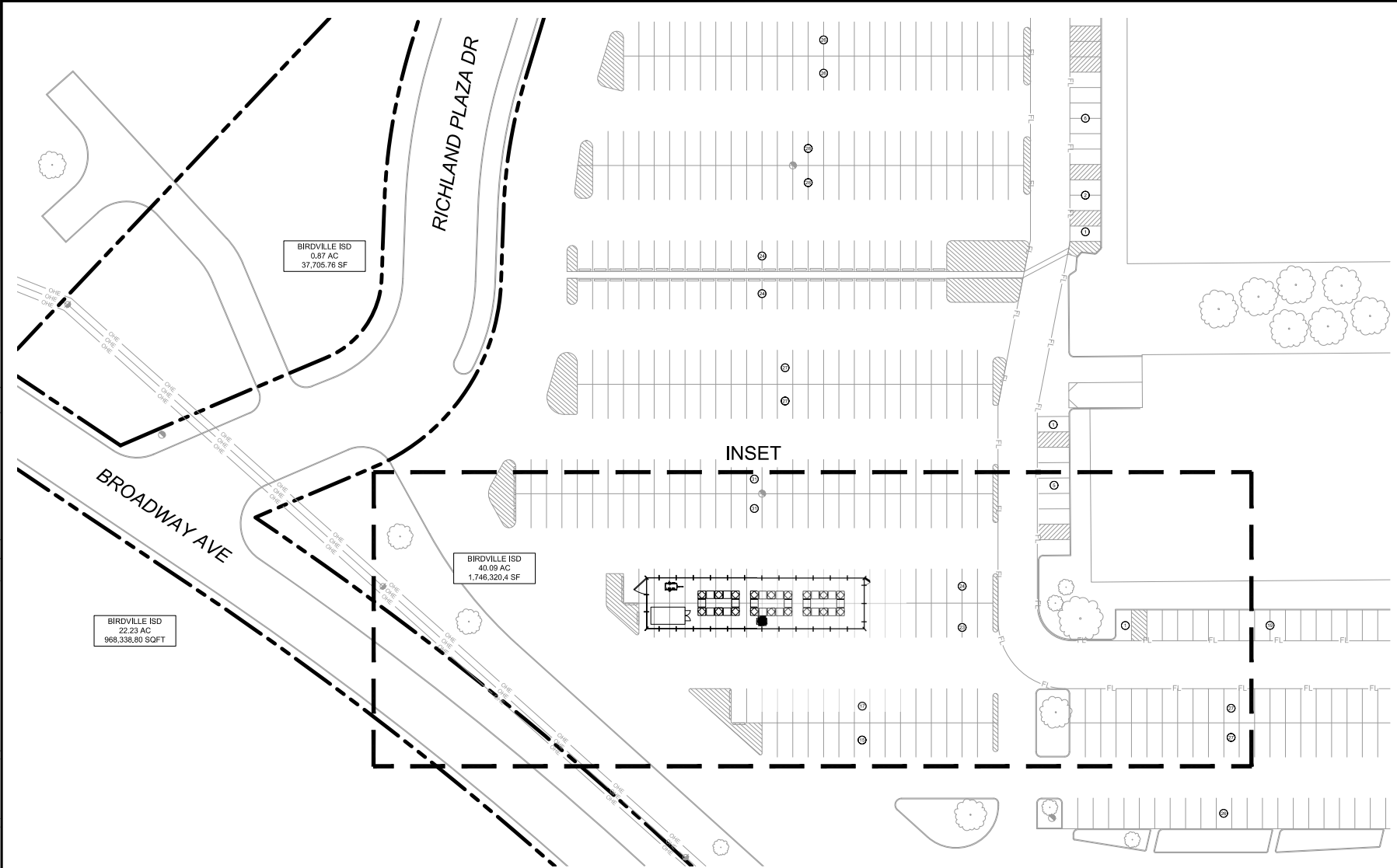

- NOTES**
- NO ON GROUND SITE TOPOGRAPHY WAS COMPLETED WITH THIS PROJECT.
 - THE SITE IS ZONED PD (PLANNED DEVELOPMENT)
 - SITE LINE WORK HAS BEEN SHOWN BASED OFF A NEARMAP AERIAL DATED JANUARY 10, 2025.

- ELECTRICAL NOTES**
- PERMANENT ELECTRIC POWER TO THE LANDING FIELD TO BE ESTABLISHED WITHIN TWELVE (12) MONTHS OF APPROVAL OF THE SPECIAL USE PERMIT.

SITE DATA SUMMARY TABLE

NAME OF PROJECT/DEVELOPMENT	NORTH RICHLAND HILLS
TAX PARCEL ID	40606775
LAND USE	DRONE LANDING SITE
TOTAL DISTURBED AREA	3810 SF
ZONING DISTRICT	PLANNED DEVELOPMENT

NO.	REVISIONS	DATE	BY

Kimley»Horn
 13455 NOEL RD, TWO GALLERIA OFFICE TOWER
 SUITE 700 DALLAS, TX 75240
 PHONE: 972-770-1300 FAX: 972-293-3820
 WWW.KIMLEY-HORN.COM TX F-828
 © 2026 KIMLEY-HORN AND ASSOCIATES, INC.

SITE PLAN FOR CITY REVIEW ONLY TO ILLUSTRATE COMPLIANCE WITH ZONING AND DEVELOPMENT REGULATIONS. IT IS NOT INTENDED FOR CONSTRUCTION PURPOSES.

KHA PROJECT	DATE	SCALE	DESIGNED BY	AGE	DRAWN BY	AGE	CHECKED BY	CMD
	APRIL 2026	AS SHOWN						

BISD PLAZA
 CITY OF NORTH RICHLAND HILLS, TX

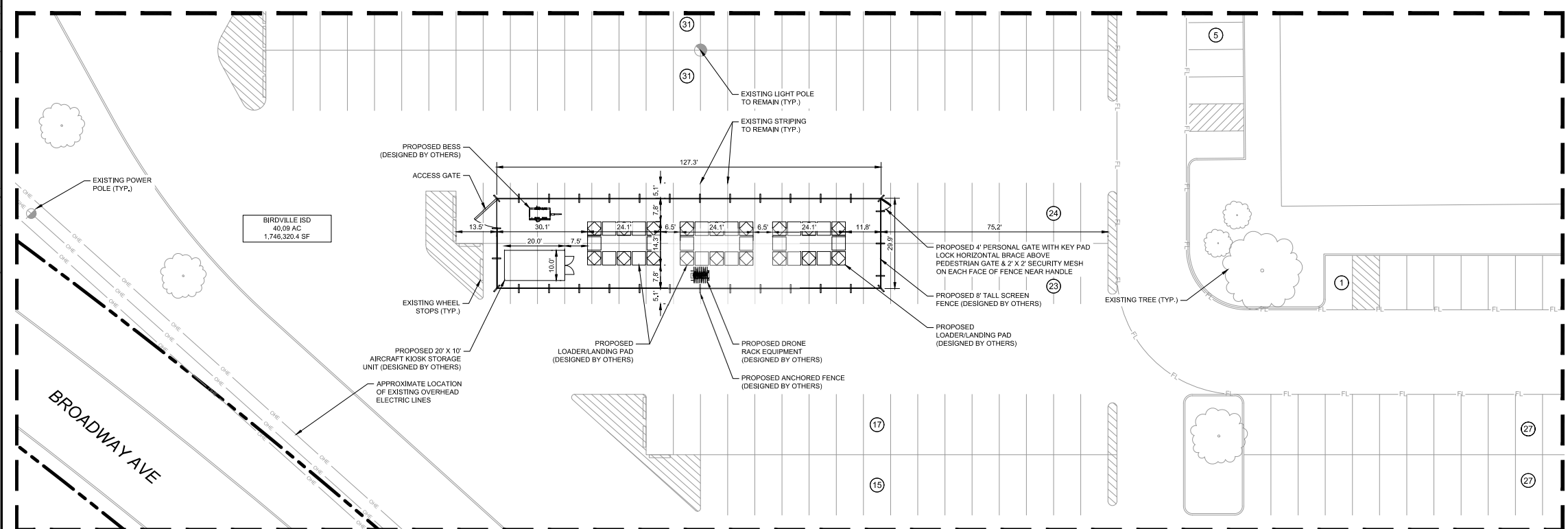

SITE PLAN
BISD PLAZA
BLOCK A LOT 1

6309 BLVD 26
 NORTH RICHLAND HILLS, TEXAS
 SUBMITTAL DATE: FEBRUARY 12, 2026

ENGINEER / APPLICANT
 KIMLEY-HORN AND ASSOCIATES, INC.
 13455 NOEL ROAD, SUITE 700
 DALLAS, TX 75240
 PHONE: (972) 919-2931
 CONTACT: CHRISTOPHER DELLS, P.E.

SITE PLAN

SHEET NUMBER
EX-1

