

EXHIBIT A

**PETITION FOR THE CREATION OF A PUBLIC IMPROVEMENT DISTRICT WITHIN
THE CITY OF NORTH RICHLAND HILLS, TEXAS FOR THE CITY POINT PUBLIC
IMPROVEMENT DISTRICT**

**PETITION FOR THE CREATION OF A PUBLIC IMPROVEMENT DISTRICT
WITHIN THE CITY OF NORTH RICHLAND HILLS, TEXAS FOR THE CITY POINT
PUBLIC IMPROVEMENT DISTRICT**

This petition ("Petition") is submitted and filed with the City Secretary of the City of North Richland Hills, Texas ("City"), by La Verne Butterfield, L.P., a California limited partnership (the "Petitioner"), owner of all of the real property located within the proposed boundaries of the District (hereinafter defined). Acting pursuant to the provisions of Chapter 372, Texas Local Government Code, as amended (the "Act"), the Petitioner requests that the City create a public improvement district (the "District"), to include certain property located within the corporate limits of the City (the "Property"), more particularly described by a metes and bounds description in **Exhibit A** and depicted in **Exhibit B**. In support of this Petition, the Petitioner would present the following:

Section 1. General Nature of the Authorized Improvements. The general nature of the proposed public improvements (collectively, the "Authorized Improvements") may include: (i) street and roadway improvements, including related sidewalks, drainage, utility relocation, signalization, landscaping, lighting, signage, off-street parking and right-of-way; (ii) establishment or improvement of parks and open space, together with the design, construction and maintenance of any ancillary structures, features or amenities such as trails, playgrounds, walkways, lighting and any similar items located therein; (iii) sidewalks and landscaping, including entry monuments and features, fountains, lighting and signage; (iv) acquisition, construction, and improvement of water, wastewater and drainage improvements and facilities; (v) projects similar to those listed in subsections (i) - (iv) above authorized by the Act, including similar off-site projects that provide a benefit to the property within the District; (vi) special supplemental services for improvement and promotion of the District; (vii) payment of costs associated with operating and maintaining the public improvements listed in subparagraphs (i) - (vi) above; and (viii) payment of costs associated with developing and financing the public improvements listed in subparagraphs (i) - (vii) above, and costs of establishing, administering and operating the District. These Authorized Improvements shall promote the interests of the City and confer a special benefit upon the Property.

Section 2. Estimated Cost of the Authorized Improvements. The estimated cost to design, acquire, and construct the Authorized Improvements, together with bond issuance costs, eligible legal and financial fees, eligible credit enhancement costs and eligible costs incurred in the establishment, administration, and operation of the District is \$15,000,000.00. The City will pay none of the costs of the proposed improvements from funds other than such assessments and possible tax increment reinvestment zone revenue. The remaining costs of the proposed improvements will be paid from sources other than the City or assessments of property owners.

Section 3. Boundaries of the Proposed District. The District is proposed to include the Property.

FILED
with City Secretary's Office

AUG -8 2019

Section 4. Proposed Method of Assessment. The City shall levy assessments on each parcel within the District in a manner that results in imposing equal shares of the costs on property similarly benefited. All assessments may be paid in full at any time (including interest and principal), and certain assessments may be paid in annual installments (including interest and principal). If an assessment is allowed to be paid in installments, then the installments must be paid in amounts necessary to meet annual costs for those Authorized Improvements financed by the assessment, and must continue for a period necessary to retire the indebtedness of those Authorized Improvements (including interest).

Section 5. Proposed Apportionment of Costs between the District and the City. The City will not be obligated to provide any funds to finance the Authorized Improvements, other than from assessments levied on the District, and possible tax increment reinvestment zone revenue. No municipal property in the public improvement district shall be assessed. The Petitioner may also pay certain costs of the improvements from other funds available to the Petitioner.

Section 6. Management of the District. The Petitioner proposes that the District be managed by the City, with the assistance of a consultant, who shall, from time to time, advise the City regarding certain operations of the District.

Section 7. The Petitioner Requests Establishment of the District. The person signing this Petition requests the establishment of the District, is duly authorized, and has the corporate authority to execute and deliver the Petition.

Section 8. Advisory Board. The Petitioner proposes that the District be established and managed without the creation of an advisory board. If an advisory board is created, the Petitioner requests that a representative of the Petitioner be appointed to the advisory board.

Section 9. Landowner(s). This Petition has been signed by (1) the owners of taxable real property representing more than 50 percent of the appraised value of taxable real property liable for assessment under the proposal, as determined by the current roll of the appraisal district in which the property is located; and (2) record owners of real property liable for assessment under the proposal who: (A) constitute more than 50 percent of all record owners of property that is liable for assessment under the proposal; or (B) own taxable real property that constitutes more than 50 percent of the area of all taxable real property that is liable for assessment under the proposal.

This Petition is hereby filed with the City Secretary of the City, or other officer performing the functions of the municipal secretary, in support of the creation of the District by the City Council of the City as herein provided. The undersigned request that the City Council of the City call a public hearing on the advisability of the Authorized Improvements, give notice thereof as provided by law and grant all matters requested in this Petition and grant such other relief, in law or in equity, to which Petitioner may show itself to be entitled.

RESPECTFULLY SUBMITTED, on this the 8th day of August, 2019.

OWNER

LA VERNE BUTTERFIELD, L.P.,
a California limited partnership

By: Chest Properties, LLC,
a Delaware limited liability company
its General Partner

By: SCKG Company, LLC
a California limited liability company
its Managing Member

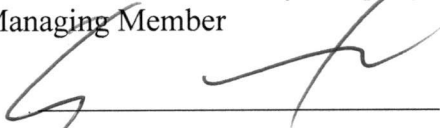
By: 

Name: Ezra Kest

Its: Manager

A notary public or other officer completing this certificate verifies only the identity of the individual who signed the document to which this certificate is attached, and not the truthfulness, accuracy, or validity of that document.

STATE OF CALIFORNIA §
 §
COUNTY OF LOS ANGELES §

This instrument was acknowledged before me on the 6 day of August, 2019 by Ezra Kest, Manager of SCKG Company, LLC, a California limited liability company, as Managing Member of Chest Properties, LLC, a Delaware limited liability company, as General Partner of La Verne Butterfield, L.P., a California limited partnership, on behalf of said partnership.

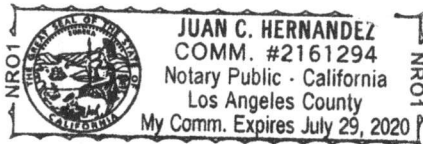



Notary Public, State of California

EXHIBIT A
Metes and Bounds
52.873 ACRES

TRACT 1:

BEING all of Lot 1, Block 3, CITY POINT ADDITION, an addition to the City of North Richland Hills, Tarrant County, Texas, according to the plat recorded in County Clerk's File No. D214125258, of the Official Public Records of Tarrant County, Texas.

TRACT 2

BEING 16.881 acres of land situated in the WILLIAM W. WALLACE SURVEY, Abstract No. 1606, North Richland Hills, Tarrant County, Texas, and being a portion of Lot 1, Block 2, CITY POINT ADDITION, an addition to the City of North Richland Hills, Tarrant County, Texas, according to the plat recorded in County Clerk's File No. D214125258, of the Official Public Records of Tarrant County, Texas, and being a portion of the tracts of land identified as Tract I, and Parcels ONE and TWO, in the deed to La Verne Butterfield, L.P., recorded in County Clerk's File No. D213022633, of the Official Public Records of Tarrant County, Texas, and also being a portion of the tract of land conveyed to La Verne Butterfield, L.P., by the deed recorded in County Clerk's File No. D214005869, of the Official Public Records of Tarrant County, Texas. Said 16.881 acres of land being more particularly described by metes and bounds as follows:

BEGINNING at a concrete Texas Electric Service Company monument found at the most Westerly Northwest corner of said Lot 1, Block 2, said point being the Northeast corner of Lot 16, Block 1, Edgley Addition, to the City of North Richland Hills, Tarrant County, Texas, according to the plat recorded in Volume 388-140, Page 11, of the Plat Records of Tarrant County, Texas, and said POINT OF BEGINNING lying in the Southeast right-of-way line of State Highway No. 26 (a variable width public right-of-way);

THENCE along the Northwest boundary line of said Lot 1, Block 2, and the Southeast right-of-way line of said State Highway No. 26, as follows:

1. N 47° 39' 42" E 413.12 feet, to a ½" iron rod marked "Brittain & Crawford" set at the beginning of a curve to the right;
2. NORTHEASTERLY 33.48 feet, along said curve to the right, having a radius of 250.00 feet, a central angle of 07° 40' 29", and a chord bearing N 51° 29' 56" E 33.46 feet, to a ½" iron rod marked "Brittain & Crawford" set at the end of said curve;

THENCE along the North boundary line of said Lot 1, Block 2, and the South boundary lines of Lot 1, Block E, Calloway Farm Addition, to the City of North Richland Hills, Tarrant County, Texas, according to the plat recorded in Cabinet "A", Slide 21590, of the Plat Records of Tarrant County, Texas, and Lot 2, Block 2, Calloway Farm Addition, to the City of North Richland Hills,

Tarrant County, Texas, according to the plat recorded in County Clerk's File No. D214125258, of the Official Public Records of Tarrant County, Texas, as follows:

1. S 42° 51' 35" E 41.46 feet, to an "X" cut in concrete set at the most Westerly Southwest corner of said Lot 1, Block E, and said point lying in the curve to the right;
2. NORTHEASTERLY 11.22 feet, along said curve to the right, having a radius of 200.50 feet, a central angle of 03° 12' 25", and a chord bearing N 74° 41' 28" E 11.22 feet, to an "X" cut in concrete set at the end of said curve;
3. N 76° 15' 24" E 261.04 feet, to an "X" cut in concrete set at the beginning of a curve to the left;
1. NORTHEASTERLY 99.70 feet, along said curve to the left, having a radius of 199.50 feet, a central angle of 28° 37' 59", and a chord bearing N 61° 57' 18" E 98.66 feet, to an "X" cut in concrete set at the end of said curve;
2. N 48° 20' 24" E 53.72 feet, to a "MAG" nail set at the beginning of a curve to the left;
3. NORTHEASTERLY 8.23 feet, along said curve to the left, having a radius of 20.00 feet, a central angle of 23° 34' 41", and a chord bearing N 35° 48' 53" E 8.17 feet, to an "X" cut in concrete set at the North corner of said Lot 1, Block 2, and said point lying in the Southwest right-of-way line of City Point Drive (a 110 foot wide public right-of-way);

THENCE along the Northeast boundary line of said Lot 1, Block 2, and the Southwest right-of-way line of said City Point Drive, as follows:

1. S 42° 23' 46" E 573.15 feet, to an "X" cut in concrete found;
2. S 06° 53' 30" E 105.89 feet, to a ½" iron rod marked "TOPOGRAPHIC" found lying at the intersection of the Southwest right-of-way line of said City Point Drive with the West right-of-way line of City Point West (a 40 foot wide public right-of-way);

THENCE continuing along the Northeast boundary line of said Lot 1, Block 2, and the West right-of-way line of City Point West, as follows:

1. S 12° 35' 44" W 47.65 feet, to an "X" cut in concrete set at the beginning of a curve to the left;
2. SOUTHEASTERLY 125.38 feet, along said curve to the left, having a radius of 271.00 feet, a central angle of 26° 30' 30", and a chord bearing S 00° 39' 31" E 124.27 feet, to a point lying at the end of said curve;
3. S 13° 54' 47" E 36.64 feet, to an "X" cut in concrete set at the beginning of a curve to the right;

4. SOUTHEASTERLY 29.57 feet, along said curve to the right, having a radius of 281.00 feet, a central angle of $06^{\circ} 01' 47''$, and a chord bearing $S 10^{\circ} 53' 53'' E$ 29.56 feet, to an "X" cut in concrete set at the Northeast corner of a proposed 10.00 acres tract of land;

THENCE severing said Lot 1, Block 2, as follows:

1. $S 89^{\circ} 37' 12'' W$ 628.11 feet, to a $\frac{1}{2}$ " iron rod marked "Brittain & Crawford" set;
2. $S 00^{\circ} 27' 51'' E$ 246.59 feet, to a $\frac{1}{2}$ " iron rod found at the Northeast corner of Ruth Road (a 50 foot wide public right-of-way);

THENCE $S 89^{\circ} 35' 09'' W$ 49.95 feet, along the North right-of-way line of said Ruth Road, to a $\frac{1}{2}$ " iron rod found at the Northwest corner of said Ruth Road;

THENCE again severing said Lot 1, Block 2, as follows:

1. $N 00^{\circ} 27' 51'' W$ 122.78 feet, to a $\frac{1}{2}$ " iron rod marked "Brittain & Crawford" set;
2. $S 89^{\circ} 35' 50'' W$ 480.59 feet, to a $\frac{1}{2}$ " iron rod marked "Brittain & Crawford" set in the West boundary line of said Lot 1, Block 2, and the East boundary line of a tract of land conveyed to ONCOR Electric Delivery Company, LLC, by the deed recorded in Volume 1947, Page 169, of the Deed Records of Tarrant County, Texas;

THENCE $N 00^{\circ} 22' 36'' W$ 473.10 feet, along the West boundary line of said Lot 1, Block 2, and the East boundary line of said ONCOR Electric Delivery Company Tract and the aforesaid Lot 16, Block 1, Edgley Addition, to the POINT OF BEGINNING containing 16.881 acres (735,331 square feet) of land.

TRACT 3:

BEING all of Lot 2, Block 1, CITY POINT ADDITION, an addition to the City of North Richland Hills, Tarrant County, Texas, according to the plat recorded in County Clerk's File No. D214125258, of the Official Public Records of Tarrant County, Texas.

TRACT 4:

BEING 0.759 acre of land situated in the WILLIAM W. WALLACE SURVEY, Abstract No. 1606, North Richland Hills, Tarrant County, Texas, and being a portion of the tract of land identified as Tract VII, in the deed to La Verne Butterfield, L.P., by the deed recorded in County Clerk's File No. D205028589, of the Official Public Records of Tarrant County, Texas. Said 0.759 acre of land being more particularly described by metes and bounds as follows:

BEGINNING at a $\frac{5}{8}$ " iron rod found at the Southwest corner of said La Verne Butterfield Tract, and the Northwest corner of Lot 9, Block A, Calloway Farm Addition, to the City of North Richland Hills, Tarrant County, Texas, according to the plat recorded in Cabinet "A", Slide 299,

CITY POINT PUBLIC IMPROVEMENT DISTRICT PETITION

of the Plat Records of Tarrant County, Texas, said point also being the Southeast corner of a tract of land identified as Tract I, and the Southerly portion of Tract II, in the aforesaid deed to La Verne Butterfield, L.P.;

THENCE N 00° 08' 55" W 50.08 feet, along the West boundary line of said Tract VII and the East boundary line of the aforesaid Tract of land identified as Tract I and the Southerly portion of the Tract II, to a ½ iron rod found at the Northwest corner of said Tract VII, and the Southwest corner of a tract of land identified as Tract II, in the deed to Columbia North Hills Hospital Subsidiary, L.P., recorded in Volume 14448, Page 33, of the Deed Records of Tarrant County, Texas;

THENCE N 89° 40' 25" E 660.60 feet, along the North boundary line of said Tract VII and the South boundary line of said Columbia North Hills Hospital Subsidiary Tract, to a ½" iron rod found at the Northeast corner of said Tract VII and the Southeast corner of said Columbia North Hills Hospital Subsidiary Tract, and said point lying in the West right-of-way line of Booth Calloway Road (a 60 foot wide public right-of-way);

THENCE S 00° 32' 11" E 49.98 feet, along the East boundary line of said Tract VII and the West right-of-way line of Booth Calloway Road, to a ½" iron rod found at the Southeast corner of said Tract VII and the Northeast corner of a tract of land identified as Tract I, in the aforesaid deed to Columbia North Hills Hospital Subsidiary, L.P.;

THENCE S 89° 39' 54" W 660.93 feet, along the South boundary line of said Tract VII and the North boundary line of said Tract I, and the aforesaid Lot 9, Block A, to the POINT OF BEGINNING containing 0.759 acre (33,059 square feet) of land.

TRACT 5:

BEING 0.169 acre of land situated in the WILLIAM W. WALLACE SURVEY, Abstract No. 1606, North Richland Hills, Tarrant County, Texas, and being a portion of the tract of land identified as "Tract I and the Southerly portion of Tract II", in the deed to La Verne Butterfield, L.P., by the deed recorded in County Clerk's File No. D205028590, of the Official Public Records of Tarrant County, Texas. Said 0.169 acre of land being more particularly described by metes and bounds as follows:

BEGINNING at a ½" iron rod found with aluminum cap marked "4873" at the Southwest corner of Lot 1, Block M, Calloway Farm Addition, to the City of North Richland Hills, Tarrant County, Texas, according to the plat recorded in Cabinet "A", Slide 11807, of the Plat Records of Tarrant County, Texas, said point lying in the Northeast right-of-way line of City Point Drive (a variable width public right-of-way);

THENCE S 89° 59' 16" E 51.30 feet, along the South boundary line of said Lot 1, Block M, and severing said La Verne Butterfield Tract, to a ½" iron rod marked "Brittain & Crawford" set at the Southeast corner of said Lot 1, Block M, and said point lying in the West boundary line of a tract of land identified as Tract II, in the deed to Columbia North Hills Hospital Subsidiary, L.P., recorded in Volume 14448, Page 33, of the Deed Records of Tarrant County, Texas;

THENCE S 00° 26' 57" E 305.54 feet, along the West boundary line of said Columbia North Hills Hospital Subsidiary Tract and the East boundary line of said La Verne Butterfield Tract, to a ½" iron rod found at the Southwest corner of said Columbia North Hills Hospital Subsidiary Tract, and the Northwest corner of a tract of land identified as Tract VII, in the aforesaid deed to La Verne Butterfield;

THENCE S 00° 08' 55" E 50.08 feet, along the West boundary line of said Tract VII, to a 5/8" iron rod found at the Southwest corner of said Tract VII and the Northwest corner of Lot 9, Block A, Calloway Farm Addition, to the City of North Richland Hills, Tarrant County, Texas, according to the plat recorded in Cabinet "A", Slide 299, of the Plat Records of Tarrant County, Texas, and said point lying in the East right-of-way line of the aforesaid City Point Drive;

THENCE along the Northeast right-of-way line of said City Point Drive and the West boundary line of the aforesaid Tract of land identified as Tract I and the Southerly portion of Tract II, as follows:

1. N 88° 42' 11" W 10.05 feet, to an "X" cut in concrete found;
2. N 00° 24' 47" W 80.00 feet, to an "X" cut in concrete found at the beginning of a curve to the left;
3. NORTHWESTERLY 279.79 feet, along said curve to the left, having a radius of 942.77 feet, a central angle of 17° 00' 15", and a chord bearing N 08° 54' 54" W 278.77 feet, to the POINT OF BEGINNING containing 0.169 acre (7,366 square feet) of land.

TRACT 6:

BEING 0.681 acre of land situated in the WILLIAM W. WALLACE SURVEY, Abstract No. 1606, North Richland Hills, Tarrant County, Texas, and being the same tract of land identified as the "Northerly portion of Tract II", in the deed to La Verne Butterfield, L.P., by the deed recorded in County Clerk's File No. D205028590, of the Official Public Records of Tarrant County, Texas. Said 0.681 acre of land being more particularly described by metes and bounds as follows:

BEGINNING at a ½" iron rod marked "SPOONER" found at the South corner of Lot 1, Block H, Calloway Farm Addition, to the City of North Richland Hills, Tarrant County, Texas, according to the plat recorded in County Clerk's File No. D194246388, of the Official Public Records of Tarrant County, Texas, and the West corner of the aforesaid La Verne Butterfield Tract, and said point lying in the Northeast right-of-way line of Rodger Line Drive (a 70 foot wide public right-of-way);

THENCE along the Southeast boundary line of said Lot 1, Block H, and the Northwest boundary line of said La Verne Butterfield Tract, as follows:

1. N 35° 00' 51" E 100.00 feet, to a ½" iron rod with aluminum cap stamped "RPLS 4873" found;
2. N 53° 58' 52" E 143.09 feet, to a ½" iron rod with aluminum cap stamped "RPLS 4873" found at the East corner of said Lot 1, Block H, and the North corner of the aforesaid La

Verne Butterfield Tract, and said point lying in the West boundary line of a tract of land conveyed to the City of North Richland Hills, by the deed recorded in Volume 10616, Page 1491, of the Deed Records of Tarrant County, Texas

THENCE along the Southwest boundary line of said La Verne Butterfield Tract and the Northeast right-of- way line of said Rodger Line Drive, as follows:

1. NORTHWESTERLY 45.05 feet, along a curve to the right, having a radius of 265.00 feet, a central angle of 09° 44' 24", and a chord bearing N 59° 51' 29" W 44.99 feet, to a ½" iron rod marked "Brittain & Crawford" set at the end of said curve;
2. N 54° 59' 09" W 169.48 feet, to the POINT OF BEGINNING containing 0.681 acre (29,645 square feet) of land.

TRACT 7:

Being 5.951 acres of land situated in the William W. Wallace Survey, Abstract No. 1606, North Richland Hills, Tarrant County, Texas, and being a portion of Lot 1, Block 2, CITY POINT ADDITION, an addition to the City of North Richland Hills, Tarrant County, Texas, according to the plat recorded in County Clerk's File No. D214125258, of the Official Public Records of Tarrant County, Texas, and being all of the tract of land identified as Tract V in the deed to La Verne Butterfield, L.P. by the deed recorded in County Clerk's File No. D205028589, of the Official Public Records of Tarrant County, Texas, and a portion of the tracts of land identified as Parcels One and Two, in the deed to LaVerne Butterfield, L.P., recorded in County Clerk's File No. D213022633, of the Official Public Records of Tarrant County, Texas. Said 5.951 acres of land being more particularly described by metes and bounds as follows:

BEGINNING at a 1/2" iron rod found at the most Westerly Southwest corner of said Lot 1, Block 2, and the Northwest corner of a tract of land conveyed to Richland Hills Methodist Church, by the deed recorded in Volume 2650, Page 247, of the Deed Records of Tarrant County, Texas, and said point lying in the East boundary line of a tract of land conveyed to ONCOR Electric Delivery Company, LLC, by deed recorded in Volume 1947, Page 169 of the Deed Records of Tarrant County, Texas;

THENCE along the West boundary line of said Lot 1, Block 2,, and the East boundary line of said ONCOR Electric Delivery Company Tract, as follows:

1. N 00°37'34" W, 482.31 feet to a 1/2" iron rod found;
2. N 00°22'36" W 57.70 feet, to a 1/2" iron rod marked "Brittain & Crawford" set;

THENCE severing said Lot 1, Block 2, as follows:

1. N 89°35'50" E 480.59 feet, to a 1/2" iron rod marked "Brittain & Crawford" set;
2. S 00°27'51" E at 122.78 feet, passing a 1/2" iron rod found at the Northwest corner of Ruth Road (a 50 foot wide public right-of-way) and continuing in all 540.00 feet, to a point lying

CITY POINT PUBLIC IMPROVEMENT DISTRICT PETITION

at the most Westerly Southeast corner of said Lot 1, Block 2, and the Northeast corner of said aforesaid tract of land conveyed to Richland Hills Methodist Church;

THENCE S 89°35'50" W 479.32 feet along the South boundary line of said Lot 1, Block 2, and the North boundary line of said Richland Hills Methodist Church Tract, to the Point of Beginning containing 5.951 acres (2569,235 square feet) of land

EXHIBIT B
Property Depiction

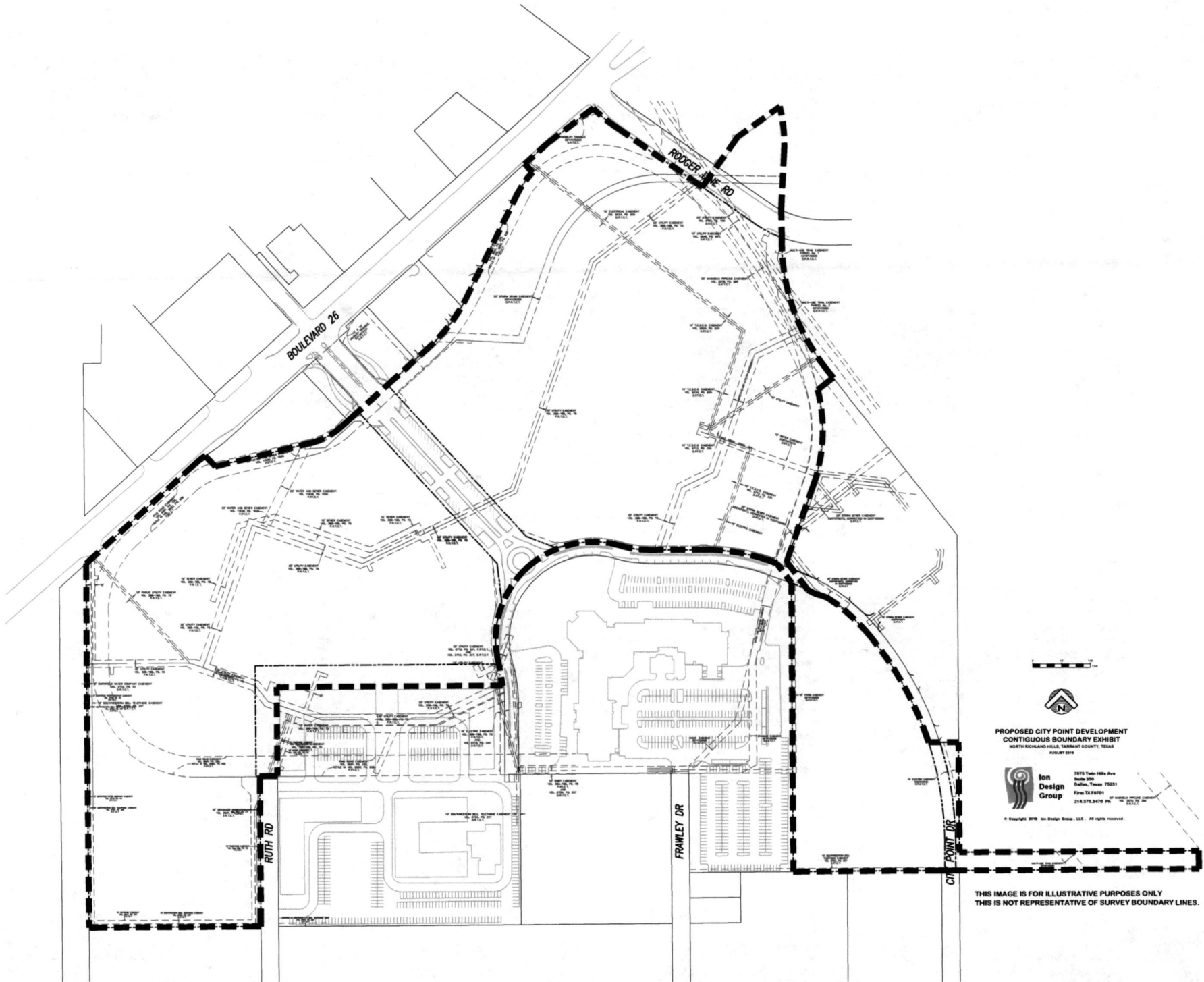

PROPOSED CITY POINT DEVELOPMENT
CONTIGUOUS BOUNDARY EXHIBIT
 NORTH RICHLAND HILLS, TARRANT COUNTY, TEXAS
 AUGUST 2019



Ion Design Group
 7075 Tudor 180a Ave
 Suite 100
 Dallas, Texas 75231
 Phone TX 972.971.1111
 214.370.3478 PA

© Copyright 2019, Ion Design Group, LLC. All rights reserved.

THIS IMAGE IS FOR ILLUSTRATIVE PURPOSES ONLY
THIS IS NOT REPRESENTATIVE OF SURVEY BOUNDARY LINES.