



PUBLIC HEARING NOTICE

CASE: ZC23-0090

You are receiving this notice because you are a property owner of record within 200 feet of the property requesting a **special use permit** as shown on the attached map.

APPLICANT	The Dog Foundry Inc
LOCATION	8100 Bedford Euless Road
REQUEST	Public hearing and consideration of a request from The Dog Foundry Inc for a special use permit for pet lodging at 8100 Bedford Euless Road, being 1.42 acres described as Lot 1, Block 1, Garvon Addition.
DESCRIPTION	Proposed day care, boarding, and grooming pet care facility. (Hounds Town USA). The business would occupy approximately 4,800 square feet.
PUBLIC HEARING DATES	Planning and Zoning Commission 7:00 PM Thursday, June 6, 2024 City Council 7:00 PM Monday, June 24, 2024
MEETING LOCATION	City Council Chamber - Third Floor 4301 City Point Drive North Richland Hills, Texas

People interested in submitting letters of support or opposition are encouraged to contact the Planning & Zoning Department for additional information. Letters must be received by the close of the City Council public hearing. Because changes are made to requests during the public hearing process, you are encouraged to follow the request through to final action by City Council.

FOR MORE INFORMATION, VISIT NRHTX.COM/MAP

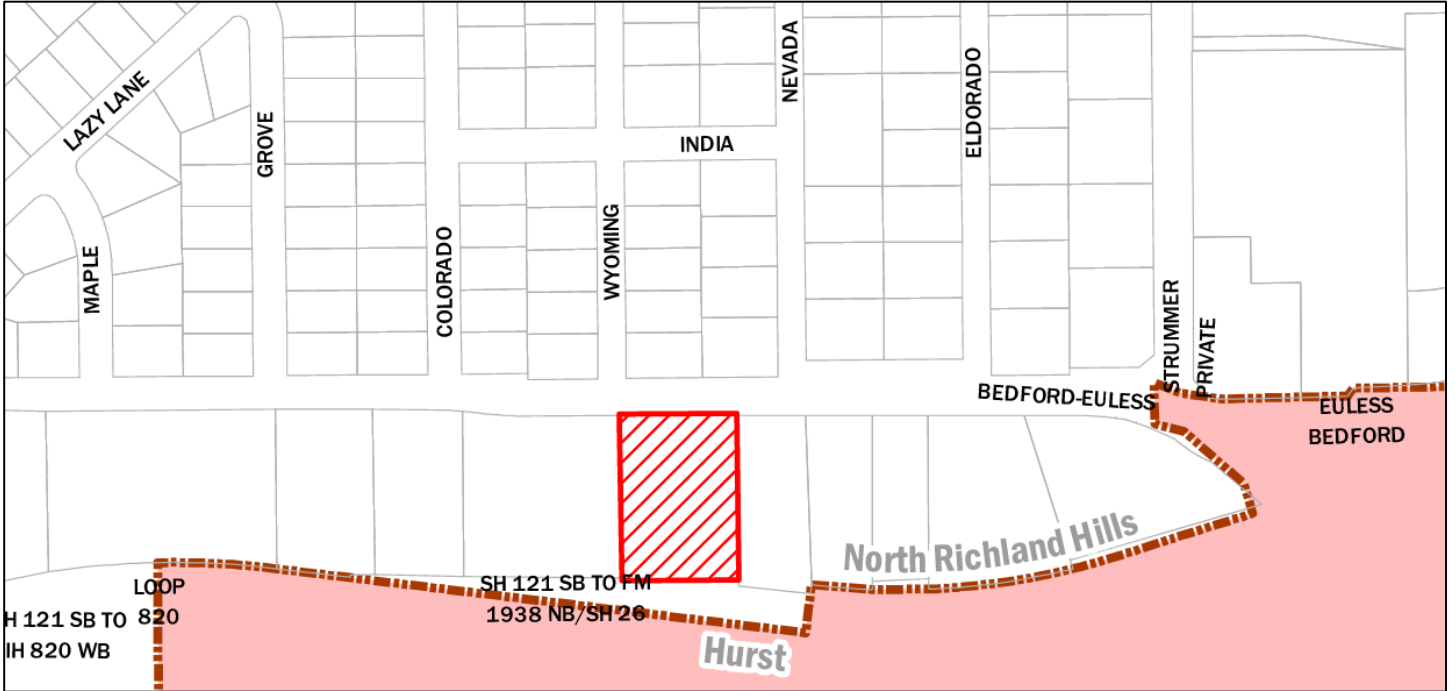

NOTIFIED PROPERTY OWNERS
ZC23-0090

OWNER	MAILING ADDRESS	CITY STATE	ZIP
8100 BEDFORD EULESS REAL ESTATE VENTURES LLC	317 CLARK AVE	WEATHERFORD TX	76085
BANDA GUTIERREZ JOSE MANUEL	4805 WYOMING TRL	NORTH RICHLAND HILLS TX	76182
CAVAZOS HOLDINGS LLC	9016 S CREST DR	NORTH RICHLAND HILLS TX	76182
ELMUSSRATI, SALEM	4804 WYOMING TRL	NORTH RICHLAND HILLS TX	76180
FCPT SW PROPERTIES LLC	1000 DARDEN CENTER DR	ORLANDO FL	32837
GARCIA, MICAELA	4800 NEVADA TRL	NORTH RICHLAND HILLS TX	76180
MCKINLEY, JAMES R	4805 NEVADA TR	NORTH RICHLAND HILLS TX	76180
RON STURGEON REAL ESTATE LP	5940 EDEN RD	HALTOM CITY TX	76117

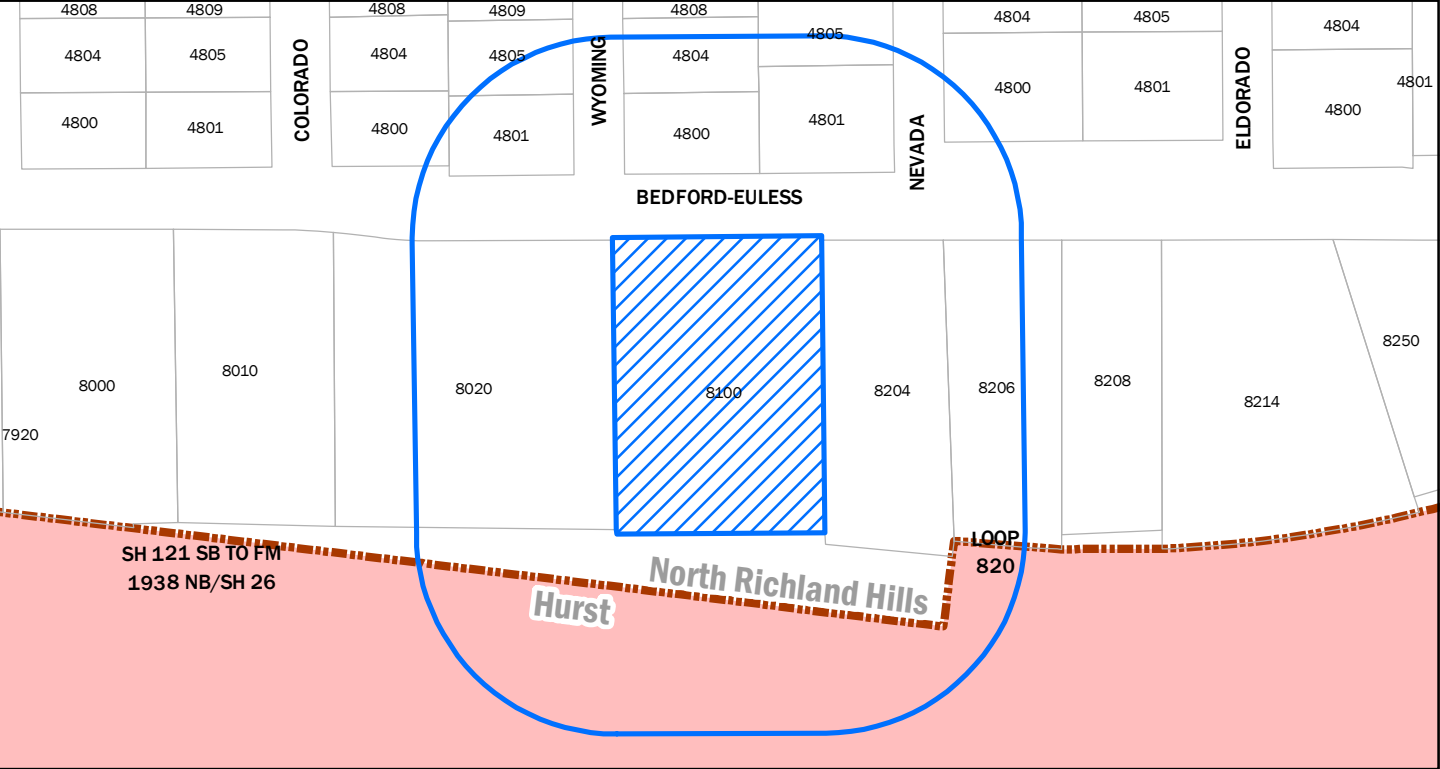

DISCLAIMER: This product is for informational purposes and may not have been prepared for or be suitable for legal, engineering, or surveying purposes. It does not represent an on-the-ground survey and represents only the approximate relative location of property boundaries.

