



PUBLIC HEARING NOTICE

CASE: ZC25-0131

«OWNER»
«MAILING_ADDRESS»
«CITY_STATE» «ZIP»

You are receiving this notice because you are a property owner of record within 200 feet of the property requesting a **special use permit** as shown on the attached map.

APPLICANT	Lisa and James Jennings
LOCATION	6129 Abbott Avenue
REQUEST	Public hearing and consideration of a request from Lisa and James Jennings for a special use permit for an accessory dwelling unit at 6129 Abbott Avenue, being 0.4026 acres described as Lot B and portions of Lot A, Block 28, College Hill Addition.
DESCRIPTION	Request for a special use permit for an accessory dwelling unit in the rear yard. The proposed building is approximately 803 square feet in size, including 650 SF of living area and 310 SF of covered porches. The building is intended to be used for living area and pool house.
PUBLIC HEARING DATES	Planning and Zoning Commission 7:00 PM Thursday, June 5, 2025 City Council 7:00 PM Monday, June 23, 2025
MEETING LOCATION	City Council Chamber - Third Floor 4301 City Point Drive North Richland Hills, Texas

People interested in submitting letters of support or opposition are encouraged to contact the Planning & Zoning Department for additional information. Letters must be received by the close of the City Council public hearing. Because changes are made to requests during the public hearing process, you are encouraged to follow the request through to final action by City Council.

A detailed map of the Mid-Cities area, showing a grid of streets and property boundaries. The streets labeled include REIS, MID-CITIES, QUEENS, HOLIDAY, COLLEGE, REGAL, (ALLEY), ABBOTT, CHAPEL, JOHNSON, PRICE, OWEN, CARDINAL, SMITHFIELD, NEWMAN, and DAVIS. A specific property is highlighted with a red hatched pattern, located at the intersection of ABBOTT and CHAPEL. The map is oriented with North at the top.

DISCLAIMER: This product is for informational purposes and may not have been prepared for or be suitable for legal, engineering, or surveying purposes. It does not represent an on-the-ground survey and represents only the approximate relative location of property boundaries.

0 75 150 300 450 600 Feet

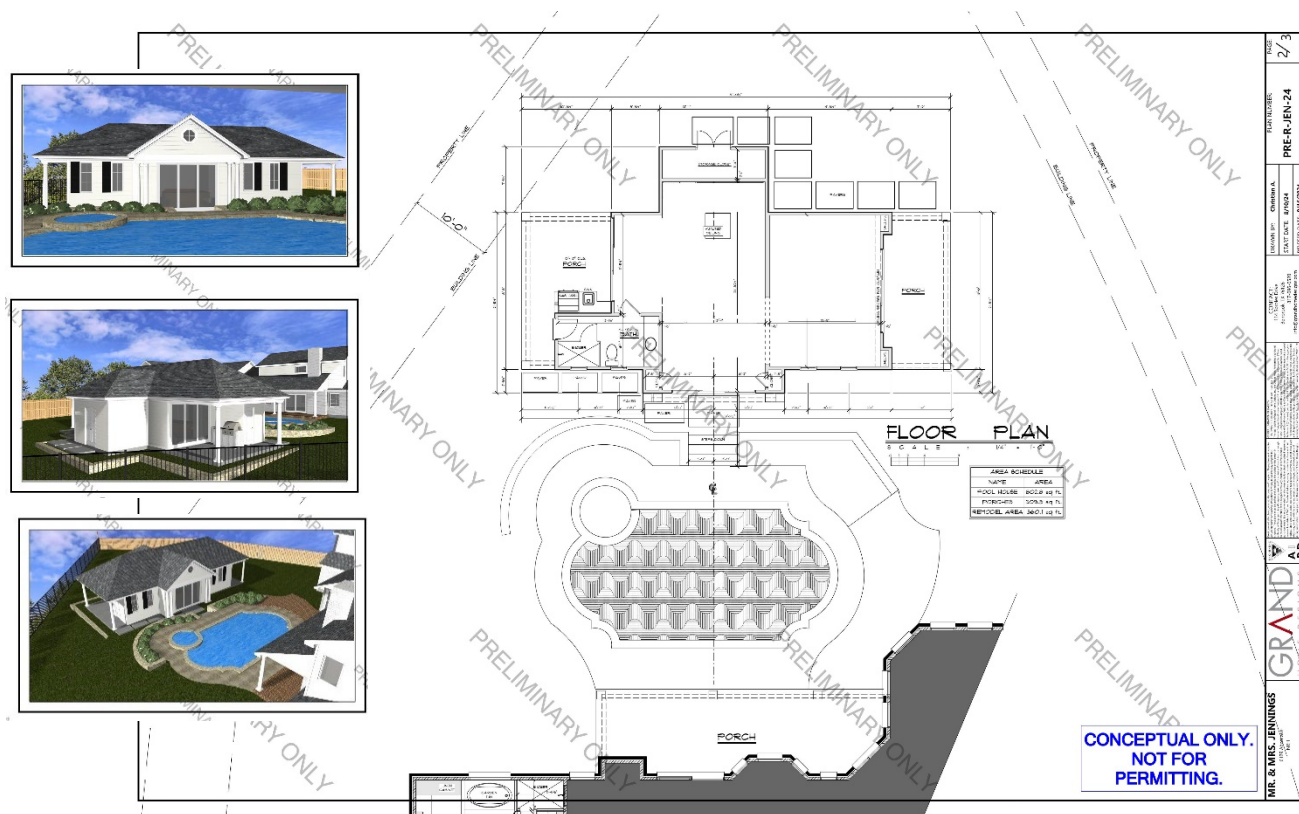

NOTIFIED PROPERTY OWNERS
ZC25-0131

OWNER	MAILING ADDRESS	CITY STATE	ZIP
ALE, RABIN	7660 REGAL LN	NORTH RICHLAND HILLS TX	76180
ATWOOD, AMY B	6209 ABBOTT AVE	NORTH RICHLAND HILLS TX	76180
BRANSCOME, RONALD B	7704 JOHNSON AVE	NORTH RICHLAND HILLS TX	76180
CALVIN, LARRY NELSON	6116 ABBOTT AVE	NORTH RICHLAND HILLS TX	76180
CARLSON, MARY ANN	7648 REGAL LN	NORTH RICHLAND HILLS TX	76180
CHRISMAN, GARY N	3 CHAPEL CT	NORTH RICHLAND HILLS TX	76180
COLLEGE HILL CHURCH OF CHRIST	7447 N COLLEGE CIR	NORTH RICHLAND HILLS TX	76180
CORLEY, AMBER	7672 REGAL LN	NORTH RICHLAND HILLS TX	76180
COX, JOHN RUSSELL	6112 ABBOTT AVE	NORTH RICHLAND HILLS TX	76180
DEAVER, ROY	6124 ABBOTT AVE	NORTH RICHLAND HILLS TX	76180
DUNHAM, BRUCE	7664 REGAL LN	NORTH RICHLAND HILLS TX	76180
FINANCE OF AMERICA REVERSE LLC	3900 CAPITAL CITY BLVD	LANSING MI	48906
FRANKLIN, GREGORY DALE	6128 ABBOTT AVE	NORTH RICHLAND HILLS TX	76180
GASPER, CHARLANNE	6854 FOUR SIXES RANCH RD	NORTH RICHLAND HILLS TX	76182
GEIGER, KENNETH	6204 ABBOTT AVE	NORTH RICHLAND HILLS TX	76180
HILLSIDE VILLAS HOMEOWNERS ASSOCIATION INC	1024 S GREENVILLE AVE STE 230	ALLEN TX	75002
HUBER, CHARLES	6200 ABBOTT AVE	NORTH RICHLAND HILLS TX	76180
JENNINGS, JAMES R	6129 ABBOTT AVE	NORTH RICHLAND HILLS TX	76180
KIM, SAM J	7636 REGAL LN	NORTH RICHLAND HILLS TX	76180
LANIER, SADIE	6205 ABBOTT AVE	NORTH RICHLAND HILLS TX	76180
LIN, YU CHEN	502 ANTLER DR	MANSFIELD TX	76063
NELSON, MATTHEW	7644 REGAL LN	NORTH RICHLAND HILLS TX	76180
RNA, TRUST	7656 REGAL LN	NORTH RICHLAND HILLS TX	76180

