



# PUBLIC HEARING NOTICE

## CASE: SRB25-0019

---

«OWNER»  
«MAILING\_ADDRESS»  
«CITY\_STATE» «ZIP»

You are receiving this notice because you are a property owner of record within 200 feet of the property requesting a sign variance as shown on the attached map.

APPLICANT	Kingfisher Realty Partners
LOCATION	5198 Rufe Snow Drive
REQUEST	Public hearing and consideration of a request from Kingfisher Realty Partners for a variance to Chapter 106 (Signs) of the North Richland Hills Code of Ordinances at 5198 Rufe Snow Drive, being 1.64 acres described as Lot 1R, Block 13, Snow Heights North Addition.
DESCRIPTION	Variance request to allow a second pole sign on the property on Rufe Snow Drive. The property is located outside of the Freeway Corridor Overlay district where pole signs are permitted.
PUBLIC HEARING DATES	Sign Review Board 7:00 PM Monday, August 11, 2025
MEETING LOCATION	City Council Chamber - Third Floor 4301 City Point Drive North Richland Hills, Texas

People interested in submitting letters of support or opposition are encouraged to contact the Planning & Zoning Department for additional information. Letters must be received by the close of the Sign Review Board public hearing. Because changes could be made to requests during the public hearing process, you are encouraged to follow the request through to final action by the Board.

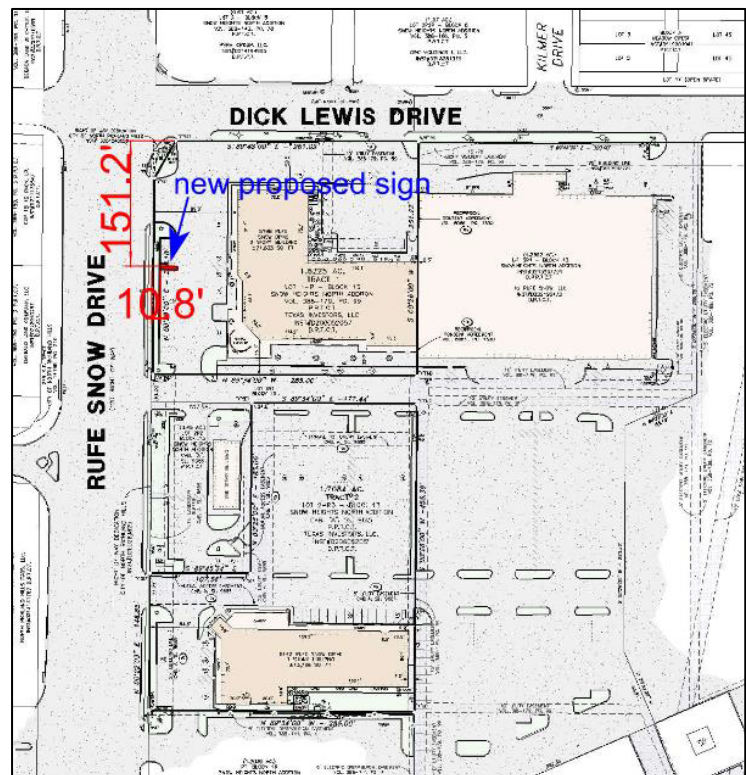
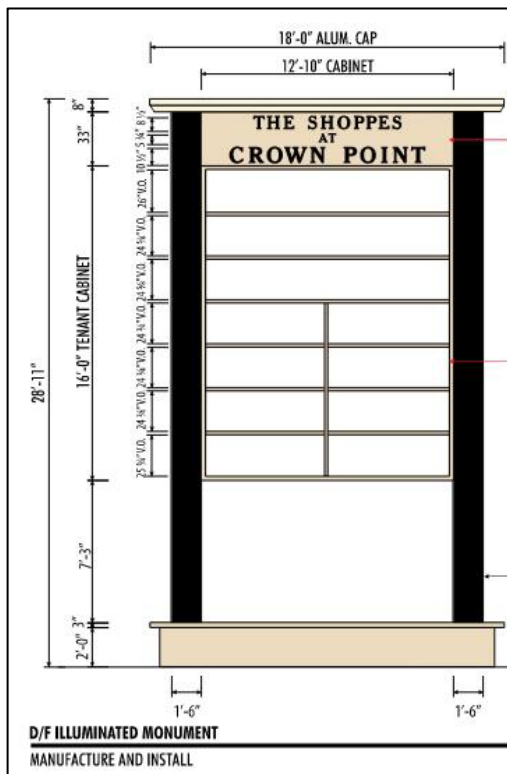
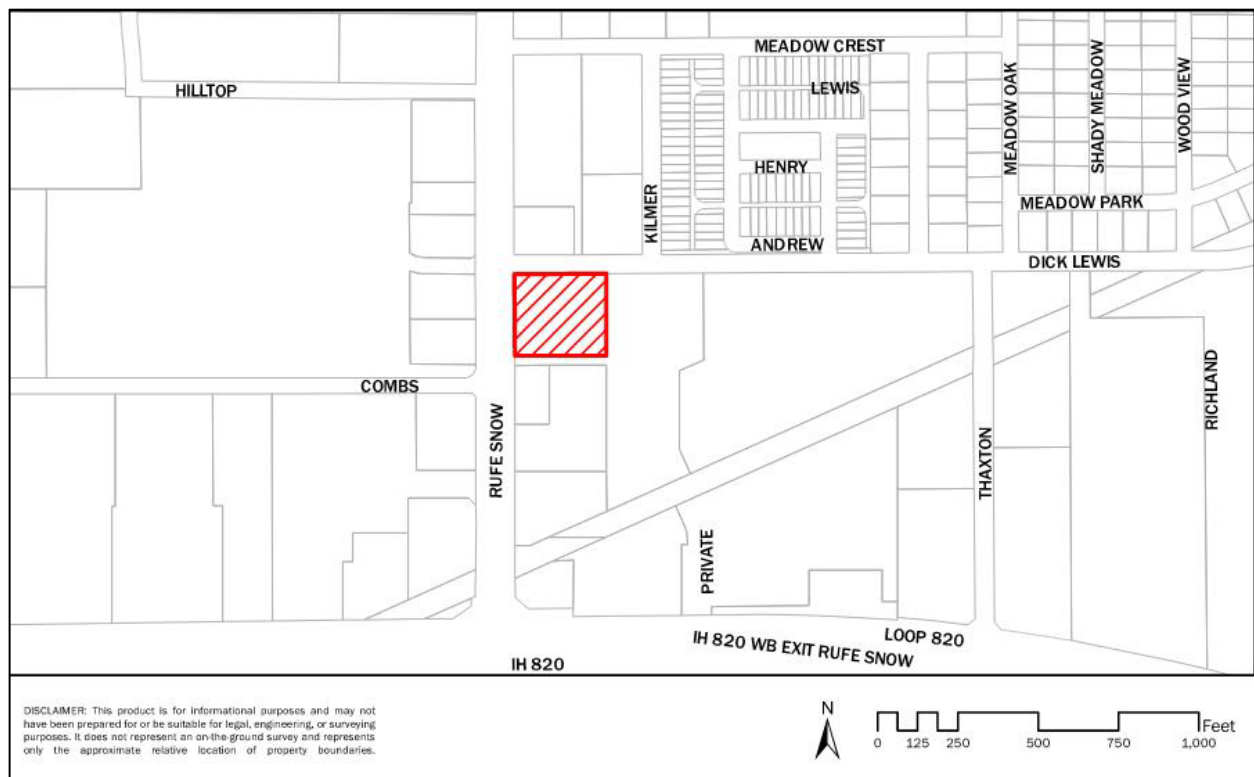

NOTIFIED PROPERTY OWNERS  
SRB25-0019

OWNER	MAILING ADDRESS	CITY STATE	ZIP
BRADBURY POINTE LLC	213 DEODAR LN	BRADBURY CA	91008
CCP TB 10 PACK LP	8333 DOUGLAS AVE STE 1500	DALLAS TX	75225
DEBACA LAND & CATTLE LLC	4653 CARMEL MTN RD #308-221	SAN DIEGO CA	92130
EMERALD LAND COMPANY LC	6300 W LOOP SOUTH STE 275	BELLAIRE TX	77401
LSB INVESTMENTS LLC	3802 E MANDEVILLE PL	ORANGE CA	92867
MEADOW CREST RESIDENTIAL HOMEOWNERS ASSOCIA	13235 DEAN WAY STE 150	SOUTHLAKE TX	76062
MG RUFE SNOW LLC	550 RESERVE ST STE 190	SOUTHLAKE TX	76092
NORTH RICHLAND HILLS PADS LLC	415 E HYMAN AVE STE 401	ASPEN CO	81611
OCW HOLDINGS I LLC	3713 EDGESTONE DR	PLANO TX	75093
RSPM GROUP LLC	5200 RUFE SNOW DR	NORTH RICHLAND HILLS TX	76180
SHELLBELL ENTERPRISES LP THE	201 SILVIA CT	LOS ALTOS CA	94024
SHOPPES CROWN POINT LLC	6405 PEMBERTON DR	DALLAS TX	75230
THOMAS, KELLI KAI	5504 KILMER DR	NORTH RICHLAND HILLS TX	76180

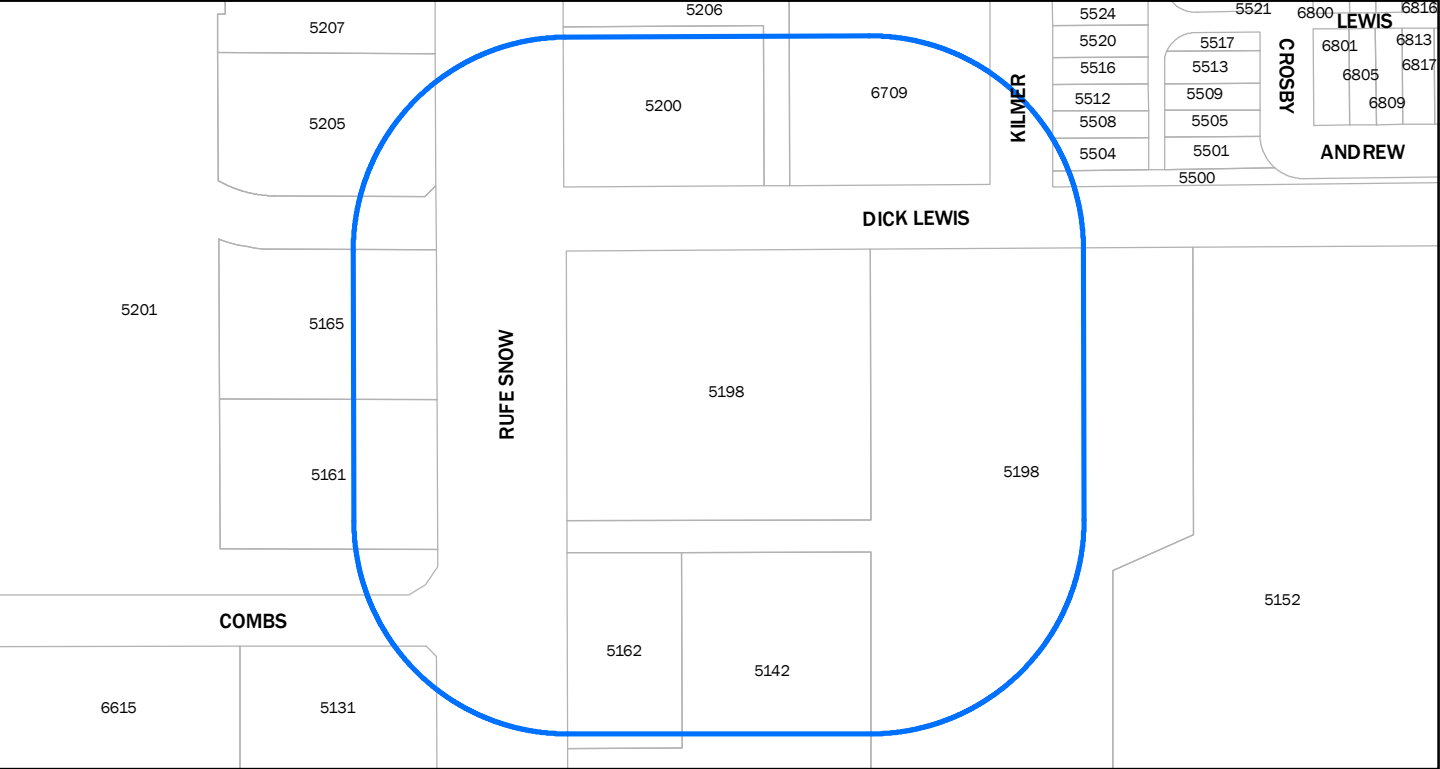

DISCLAIMER: This product is for informational purposes and may not have been prepared for or be suitable for legal, engineering, or surveying purposes. It does not represent an on-the-ground survey and represents only the approximate relative location of property boundaries.

